

MSNAP-WR72 Rail x 1

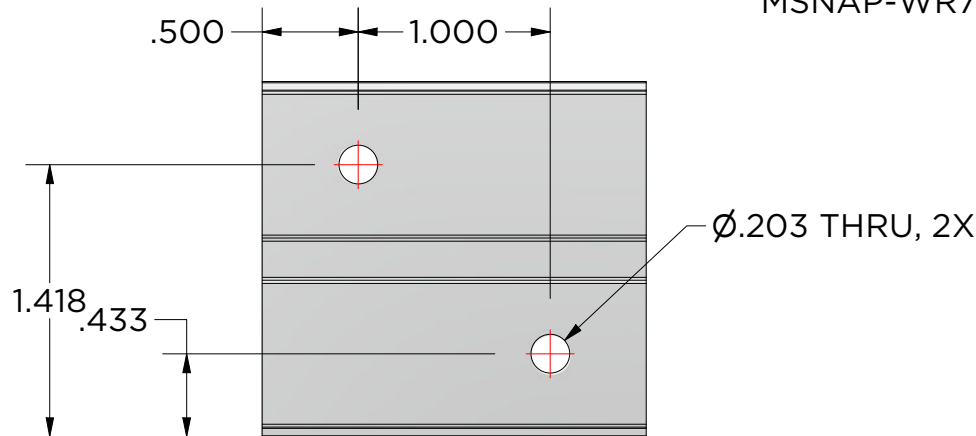

MSNAP-PC2 x 6

<b>Created By:</b> amh	<b>Approved By:</b> AMH	<b>Sheet Size</b> A	<b>Sheet No.</b> 1/1
<b>Creation Date:</b> 9/7/2023	<b>Approval Date:</b> 8/7/2024	<b>Scale</b> 1:3	<b>Rev</b>

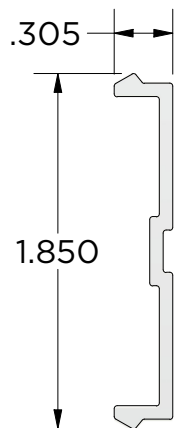
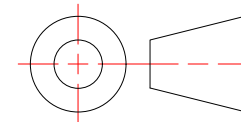

**MSNAP-72L Module**

Weight: 1.299 lbmass  
Aluminum 6063  
Finish: Mill



**MONARCH**  
METAL INC.

**PROPRIETARY AND CONFIDENTIAL**

THE INFORMATION CONTAINED IN THIS DRAWING IS THE SOLE PROPERTY OF MONARCH METAL FABRICATION. ANY REPRODUCTION IN PART OR AS A WHOLE WITHOUT THE WRITTEN PERMISSION OF MONARCH METAL INC. IS PROHIBITED.

<b>New York</b> 1700 Ocean Ave Suite 2 Ronkonkoma NY 11779 Phone: (631) 750-3000	<b>Nevada</b> 1080 Linda Way, Unit 10 Sparks, NV 89431 Phone: (775) 415-0100	<b>Texas</b> 1330 Post & Paddock St., Suite 800 Grand Prairie, TX 75050 (945) 202-2700
---	---	--

monarchmetal.com

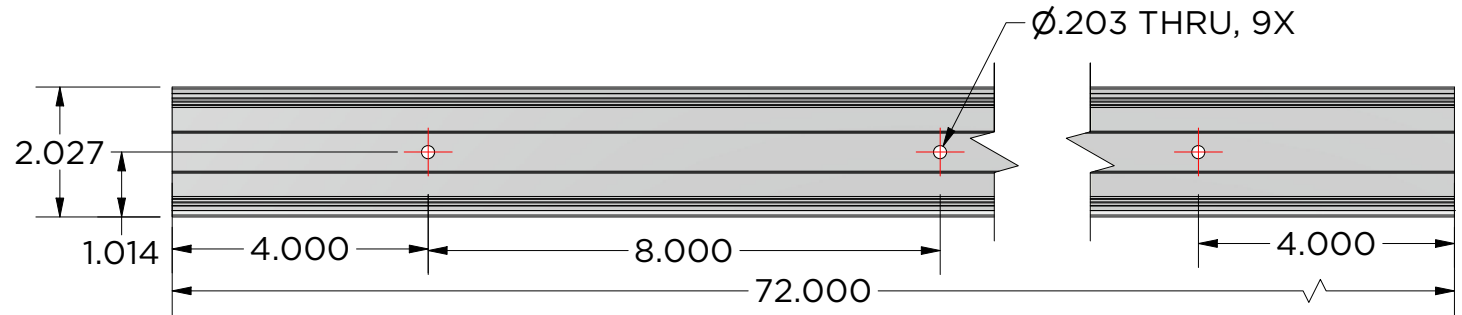
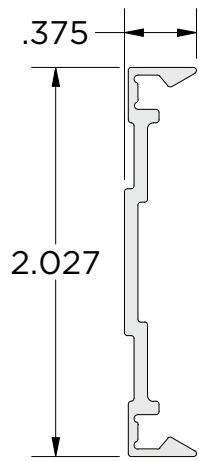

MSNAP-WR72 Rail x 1

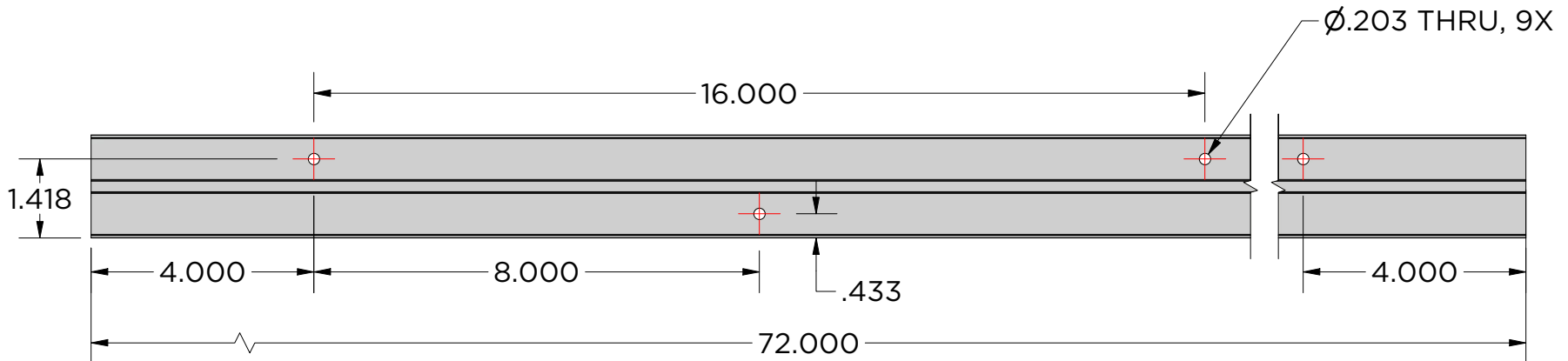
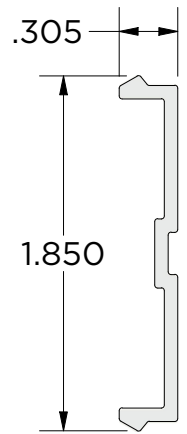

MSNAP-PR72 x 1

<b>Created By:</b> amh	<b>Approved By:</b> AMH	<b>Sheet Size</b> A	<b>Sheet No.</b> 1/1
<b>Creation Date:</b> 9/7/2023	<b>Approval Date:</b> 8/7/2024	<b>Scale</b> 1:1	<b>Rev</b>

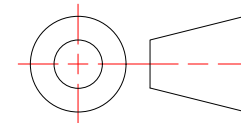

**MSNAP-72H Module**

Weight: 1.299 lbmass  
Aluminum 6063  
Finish: Mill



**MONARCH**  
METAL INC.

**PROPRIETARY AND CONFIDENTIAL**

THE INFORMATION CONTAINED IN THIS DRAWING IS THE SOLE PROPERTY OF MONARCH METAL FABRICATION. ANY REPRODUCTION IN PART OR AS A WHOLE WITHOUT THE WRITTEN PERMISSION OF MONARCH METAL INC. IS PROHIBITED.

<b>New York</b> 1700 Ocean Ave Suite 2 Ronkonkoma NY 11779 Phone: (631) 750-3000	<b>Nevada</b> 1080 Linda Way, Unit 10 Sparks, NV 89431 Phone: (775) 415-0100	<b>Texas</b> 1330 Post & Paddock St., Suite 800 Grand Prairie, TX 75050 (945) 202-2700
---	---	--

monarchmetal.com

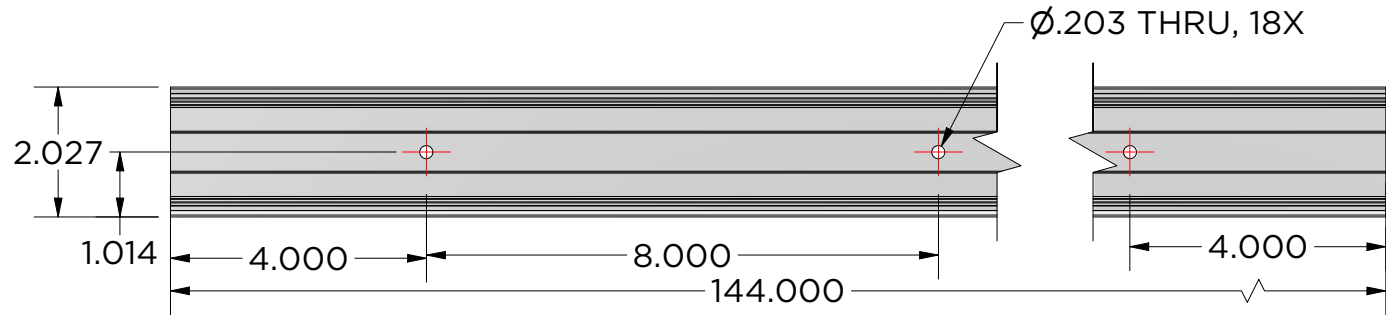
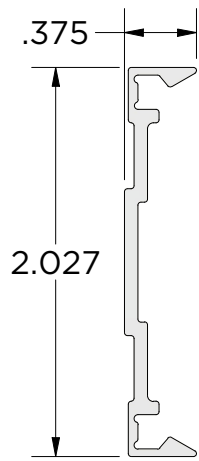

MSNAP-WR144 Rail x 1

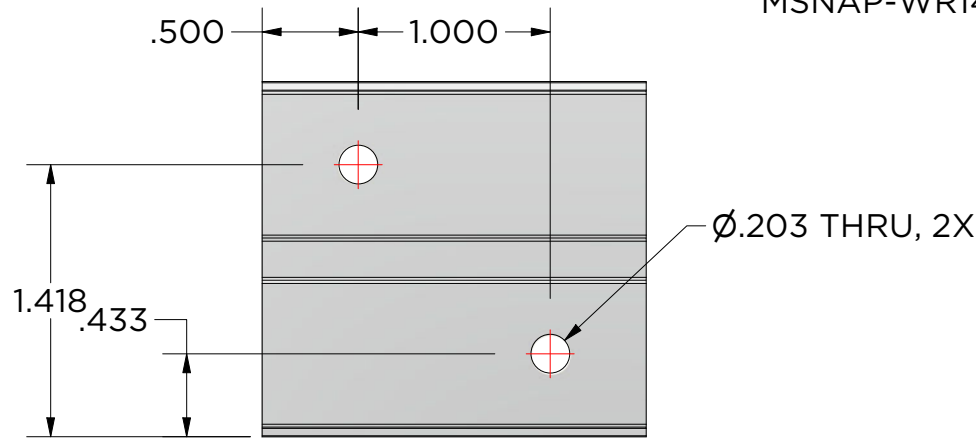
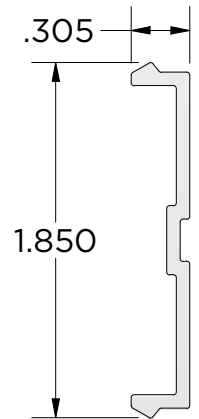

MSNAP-PC2 x 12

<b>Created By:</b> amh	<b>Approved By:</b> AMH	<b>Sheet Size</b> A	<b>Sheet No.</b> 1/1
<b>Creation Date:</b> 9/7/2023	<b>Approval Date:</b> 8/7/2024	<b>Scale</b> 1:3	<b>Rev</b>

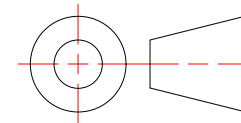

**MSNAP-144L Module**

Weight: 2.599 lbmass  
Aluminum 6063  
Finish: Mill



**MONARCH**  
METAL INC.

**PROPRIETARY AND CONFIDENTIAL**

THE INFORMATION CONTAINED IN THIS DRAWING IS THE SOLE PROPERTY OF MONARCH METAL FABRICATION. ANY REPRODUCTION IN PART OR AS A WHOLE WITHOUT THE WRITTEN PERMISSION OF MONARCH METAL INC. IS PROHIBITED.

<b>New York</b> 1700 Ocean Ave Suite 2 Ronkonkoma NY 11779 Phone: (631) 750-3000	<b>Nevada</b> 1080 Linda Way, Unit 10 Sparks, NV 89431 Phone: (775) 415-0100	<b>Texas</b> 1330 Post & Paddock St., Suite 800 Grand Prairie, TX 75050 (945) 202-2700
---	---	--

monarchmetal.com

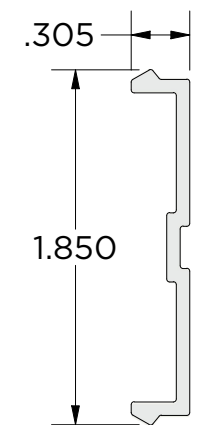
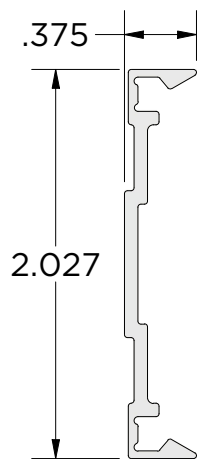

MSNAP-PR144 x 1

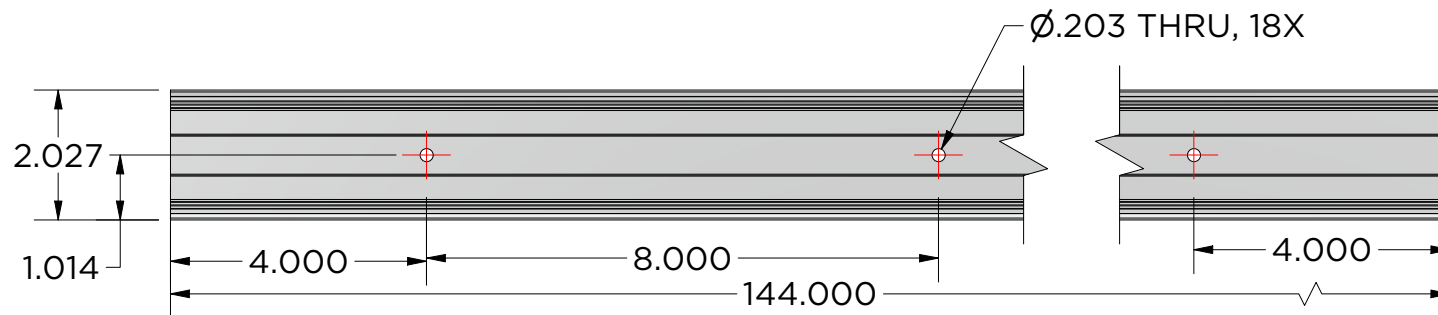

MSNAP-WR144 Rail x 1

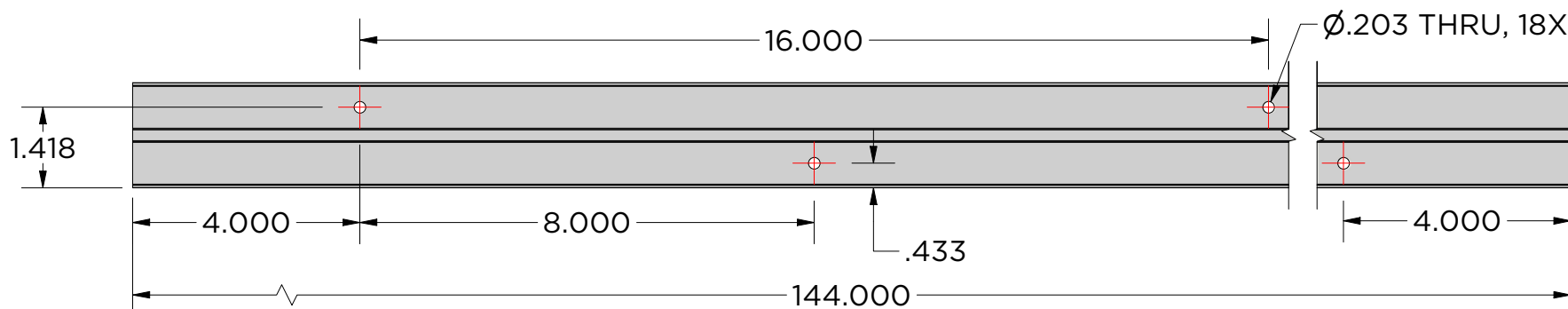

<b>Created By:</b> amh	<b>Approved By:</b> AMH	<b>Sheet Size</b> A	<b>Sheet No.</b> 1/1
<b>Creation Date:</b> 9/7/2023	<b>Approval Date:</b> 8/7/2024	<b>Scale</b> 1:1	<b>Rev</b>

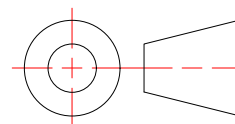

**MSNAP-144H Module**

Weight: 2.599 lbmass  
Aluminum 6063  
Finish: Mill



**MONARCH**  
METAL INC.

**PROPRIETARY AND CONFIDENTIAL**

THE INFORMATION CONTAINED IN THIS DRAWING IS THE SOLE PROPERTY OF MONARCH METAL FABRICATION. ANY REPRODUCTION IN PART OR AS A WHOLE WITHOUT THE WRITTEN PERMISSION OF MONARCH METAL INC. IS PROHIBITED.

<b>New York</b> 1700 Ocean Ave Suite 2 Ronkonkoma NY 11779 Phone: (631) 750-3000	<b>Nevada</b> 1080 Linda Way, Unit 10 Sparks, NV 89431 Phone: (775) 415-0100	<b>Texas</b> 1330 Post & Paddock St., Suite 800 Grand Prairie, TX 75050 (945) 202-2700
---	---	--

monarchmetal.com