

MFSTR-050 Attachment System

Product Category	Cladding
Product Name	MFSTR-050
Material	6063-T6 Aluminum
Finish	N/A

Geometric Properties

Depth (Assembled)	0.050 in
Design Thickness	0.125 in
Tolerance	????
Yield strength, Fy	25.0 ksi
Ultimate strength, Fu	30.0 ksi

Gross Section Properties of Full Section, Strong Axis

Cross section area (A)	0.294 in(^2)
Member weight per foot of length	0.350 lb/ft
Moment of inertia (Ix)	0.064 in(^4)
Radius of gyration (Rx)	0.467 in
Section Modulus (Sx)	0.081 in(^3)

Gross Section Properties of Full Section, Weak Axis

Cross section area (A)	0.294 in(^2)
Member weight per foot of length	0.350 lb/ft
Gross moment of inertia (Iy)	0.007 in(^4)
Gross radius of gyration (Ry)	0.149 in
Section Modulus (Sy)	0.022 in(^3)

Product Data & Ordering Information:

Stock length	6'-0" and 12'-0" long pieces
Packaging	Custom Pallet
Packaging weight	Custom

ASTM & Code Standards:

- Aluminum extrusion meets or exceed requirements of ASTM B221
- SDS Information is available by contacting [zclip@monarchmetal.com](mailto:zclip@monarchmetal.com)

Allowable Spans for Brackets

- Allowable spans for brackets will depend upon the conditions of the installation including, but not limited to, the substrate the rails are attaching to, the panel composition, the fasteners selected and the wind conditions. Please consult a structural engineer for additional information.
- Monarch Metal provides typical as well as thermally isolated substructure.

Sustainability Credits:

For more details and LEED letters contact 631-750-3000

MFSTR-050 Attachment System

Used in rain screen attachment applications:

- Concealed installation of stone, fiber cement, HPL or fiber concrete panels
- Highly corrosion resistant

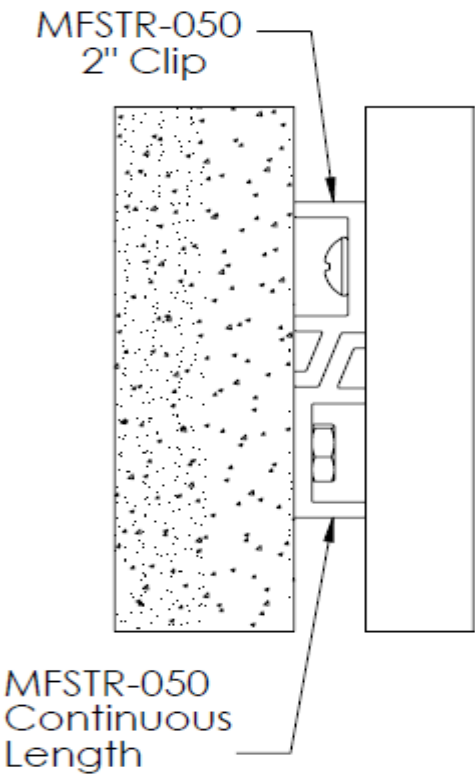

Project Information

Name:  
Address:

Contractor Information

Name:  
Contact:  
Phone:  
Fax:

Architect Information

Name:  
Contact:  
Phone:  
Fax: