

Monarch MSLAT-30-S-96x48-2 Kit

- Includes:
 (31) MSLAT-30-S
 (1) MSLATSR
 (1) MSLATHT
 (4) MSLATVT

Fasteners Not Included
 #8 - Cabinet Screws Recommended

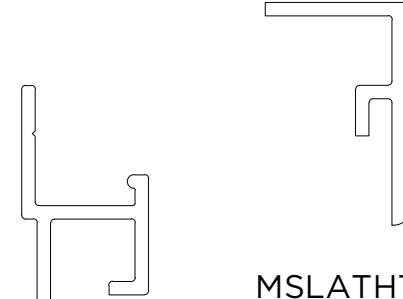
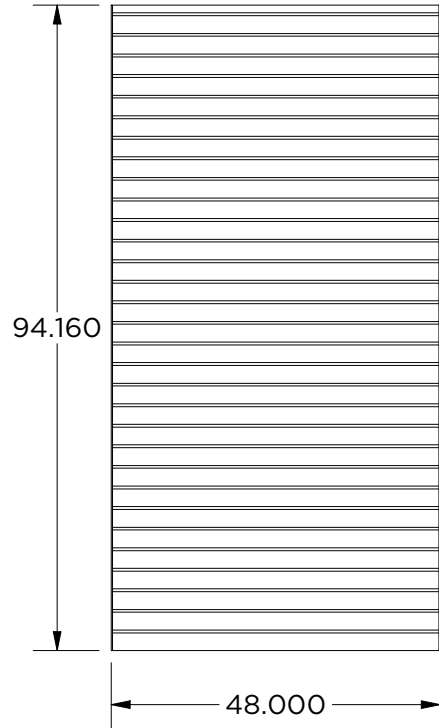

MSLATHT
SCALE 1:1

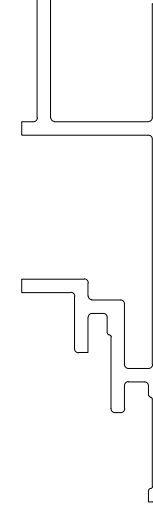

MSLAT-30-S
SCALE 1:1

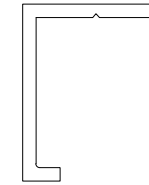

MSLATVT
SCALE 1:1

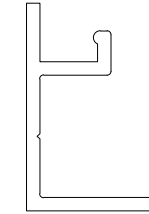

MSLATSR
SCALE 1:1

Created By: amh	Approved By:	Sheet Size A	Sheet No. 3/3
Creation Date: 1/30/2025	Approval Date:	Scale 1/28	Rev

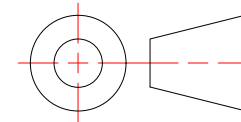

MSLAT-30-S-96x48-2

Weight: 87.295 lbmass

Finish: Mill



MONARCH
METAL INC.

PROPRIETARY AND CONFIDENTIAL

THE INFORMATION CONTAINED IN THIS DRAWING IS THE SOLE PROPERTY OF MONARCH METAL FABRICATION. ANY REPRODUCTION IN PART OR AS A WHOLE WITHOUT THE WRITTEN PERMISSION OF MONARCH METAL INC. IS PROHIBITED.

New York
 1700 Ocean Ave Suite 2
 Ronkonkoma NY 11779
 Phone: (631) 750-3000

Nevada
 1080 Linda Way, Unit 10
 Sparks, NV 89431
 Phone: (775) 415-0100

Texas
 1330 Post & Paddock St.,
 Suite 800
 Grand Prairie, TX 75050
 (945) 202-2700

monarchmetal.com