

Monarch MSLAT-30-S-48x96-2 Kit

- Includes:
 (16) MSLAT-30-S
 (1) MSLATSR
 (1) MSLATHT
 (2) MSLATVT

Fasteners Not Included
 #8 - Cabinet Screws Recommended

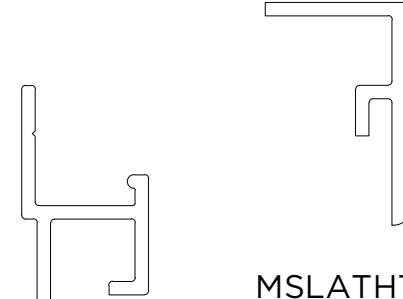
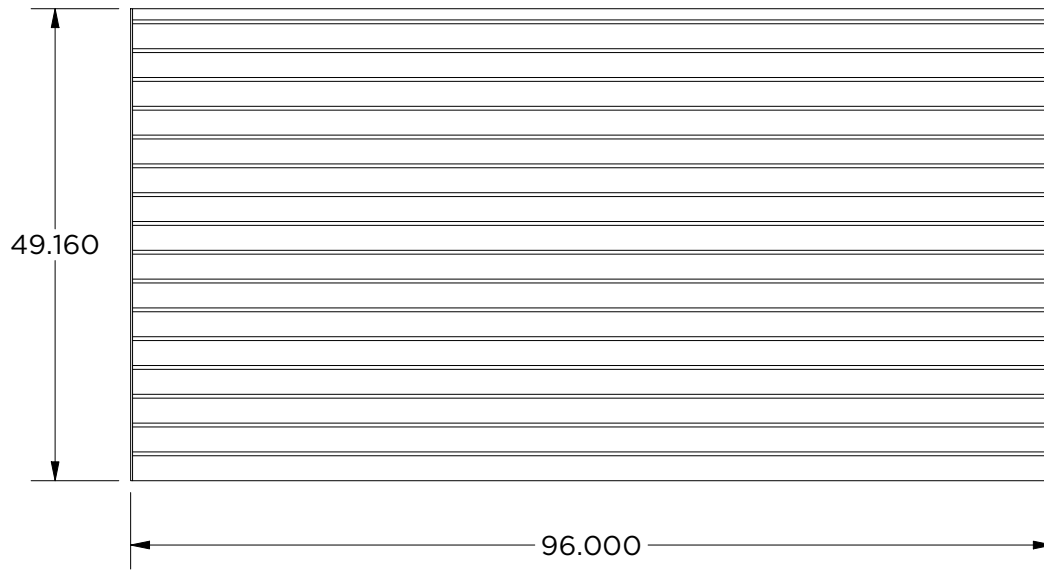

MSLATHT
SCALE 1:1

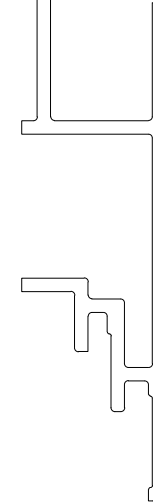

MSLAT-30-S
SCALE 1:1

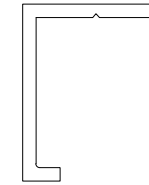

MSLATVT
SCALE 1:1

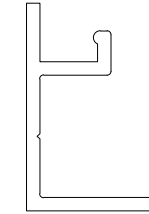

MSLATSR
SCALE 1:1

Created By: amh	Approved By:	Sheet Size A	Sheet No. 2/3
Creation Date: 1/30/2025	Approval Date:	Scale 1/20	Rev

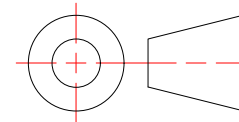

MSLAT-30-S-48x96-2

Weight: 90.643 lbmass

Finish: Mill



MONARCH
METAL INC.

PROPRIETARY AND CONFIDENTIAL

THE INFORMATION CONTAINED IN THIS DRAWING IS THE SOLE PROPERTY OF MONARCH METAL FABRICATION. ANY REPRODUCTION IN PART OR AS A WHOLE WITHOUT THE WRITTEN PERMISSION OF MONARCH METAL INC. IS PROHIBITED.

New York
 1700 Ocean Ave Suite 2
 Ronkonkoma NY 11779
 Phone: (631) 750-3000

Nevada
 1080 Linda Way, Unit 10
 Sparks, NV 89431
 Phone: (775) 415-0100

Texas
 1330 Post & Paddock St.,
 Suite 800
 Grand Prairie, TX 75050
 (945) 202-2700

monarchmetal.com