

# Monarch MSLAT-30-96x48-CL Kit

- Includes:  
 (31) MSLAT-30  
 (1) MSLATSR  
 (1) MSLATHT  
 (4) MSLATVT

Fasteners Not Included  
 #8 - Cabinet Screws Recommended

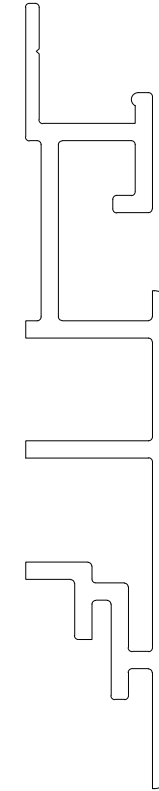
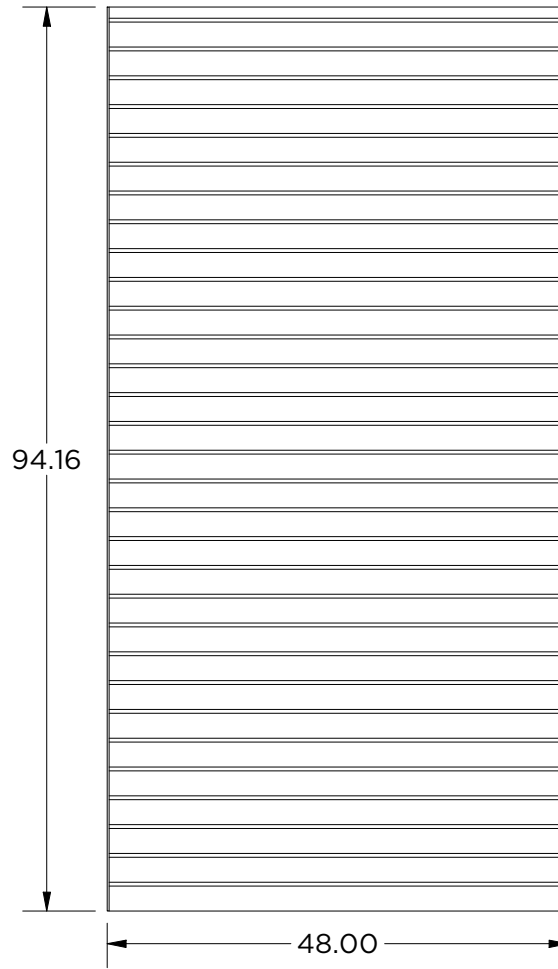

MSLAT-30  
SCALE 1:1

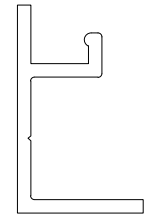

MSLATSR  
SCALE 1:1

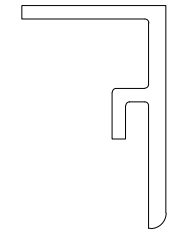

MSLATHT  
SCALE 1:1



MSLATVT  
SCALE 1:1

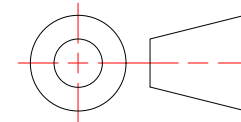

<b>Created By:</b> amh	<b>Approved By:</b> amh	<b>Sheet Size</b> A	<b>Sheet No.</b> 6/6
<b>Creation Date:</b> 3/21/2022	<b>Approval Date:</b> 3/21/2022	<b>Scale</b> 1:20	<b>Rev</b> 1

## MSLAT-30-96x48-CL

Stackable Slatwall Kit, Compatible with Standard Slatwall Accessories

Weight: 109.423 lbmass

Finish: Clear Anodized



**MONARCH**  
METAL INC.

### PROPRIETARY AND CONFIDENTIAL

THE INFORMATION CONTAINED IN THIS DRAWING IS THE SOLE PROPERTY OF MONARCH METAL FABRICATION. ANY REPRODUCTION IN PART OR AS A WHOLE WITHOUT THE WRITTEN PERMISSION OF MONARCH METAL INC. IS PROHIBITED.

**New York**  
1700 Ocean Ave Suite 2  
Ronkonkoma NY 11779  
Phone: (631) 750-3000

**Nevada**  
1080 Linda Way, Unit 10  
Sparks, NV 89431  
Phone: (775) 415-0100

**Texas**  
1330 Post & Paddock St.,  
Suite 800  
Grand Prairie, TX 75050  
(945) 202-2700

monarchmetal.com