

Created By: AMH	Approved By: AMH	Sheet Size A	Sheet No. 1/9
Creation Date: 9/27/2022	Approval Date: 9/27/2022	Scale 1:1	Rev

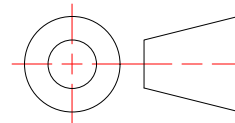

MFSTR-050 Assembly

Clip and Continuous Rail, Compatible with 1/4" Diameter Fasteners. 7/16" Liftoff

Weight: 3.516 lbmass

Finish: Mill



MONARCH
METAL INC.

PROPRIETARY AND CONFIDENTIAL

THE INFORMATION CONTAINED IN THIS DRAWING IS THE SOLE PROPERTY OF MONARCH METAL FABRICATION. ANY REPRODUCTION IN PART OR AS A WHOLE WITHOUT THE WRITTEN PERMISSION OF MONARCH METAL INC. IS PROHIBITED.

New York
1700 Ocean Ave Suite 2
Ronkonkoma NY 11779
Phone: (631) 750-3000

Nevada
1080 Linda Way, Unit 10
Sparks, NV 89431
Phone: (775) 415-0100

Texas
1330 Post & Paddock St.,
Suite 800
Grand Prairie, TX 75050
(945) 202-2700

monarchmetal.com

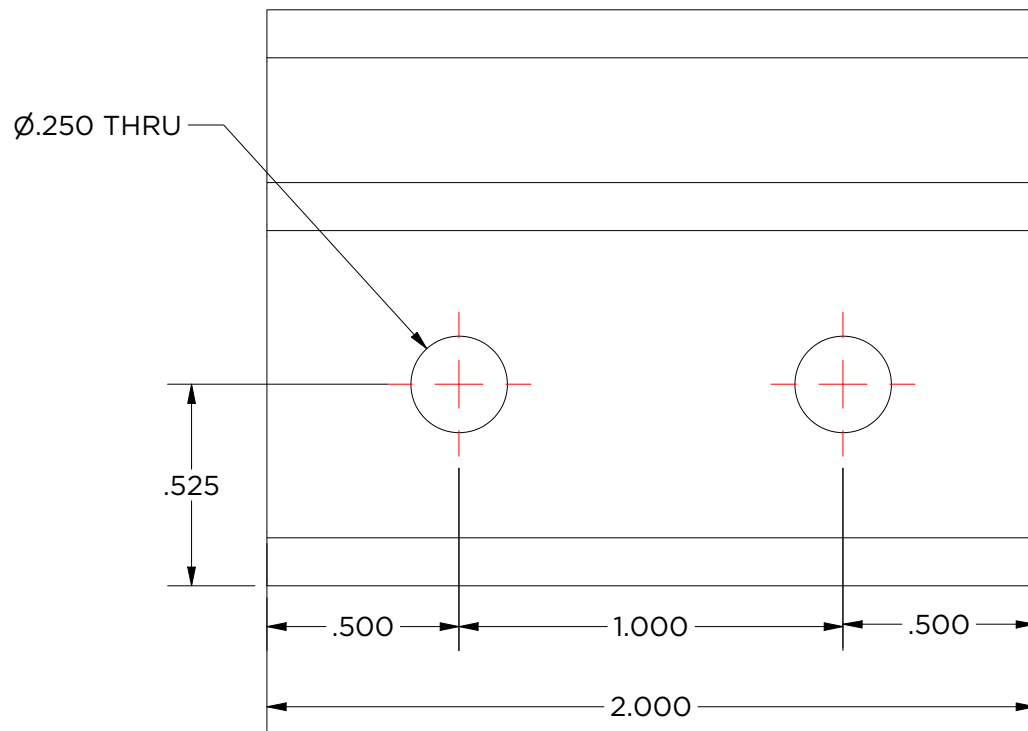
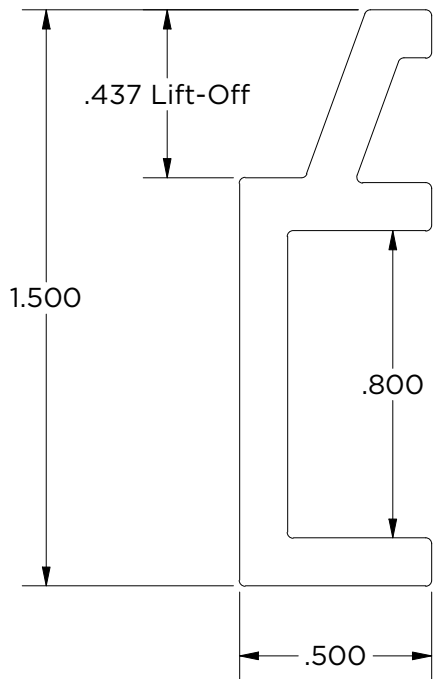

Created By: AMH	Approved By: AMH	Sheet Size A	Sheet No. 2/9
Creation Date: 9/27/2022	Approval Date: 9/27/2022	Scale 2 : 1	Rev

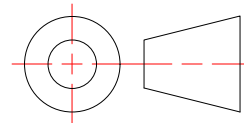

MFSTR-050-2
Heavy Duty 1/2" Clip

Weight: 0.056 lbmass
Aluminum 6063
Finish: Mill Finish



MONARCH
METAL INC.

PROPRIETARY AND CONFIDENTIAL

THE INFORMATION CONTAINED IN THIS DRAWING IS THE SOLE PROPERTY OF MONARCH METAL FABRICATION. ANY REPRODUCTION IN PART OR AS A WHOLE WITHOUT THE WRITTEN PERMISSION OF MONARCH METAL INC. IS PROHIBITED.

New York
1700 Ocean Ave Suite 2
Ronkonkoma NY 11779
Phone: (631) 750-3000

Nevada
1080 Linda Way, Unit 10
Sparks, NV 89431
Phone: (775) 415-0100

Texas
1330 Post & Paddock St.,
Suite 800
Grand Prairie, TX 75050
(945) 202-2700

monarchmetal.com

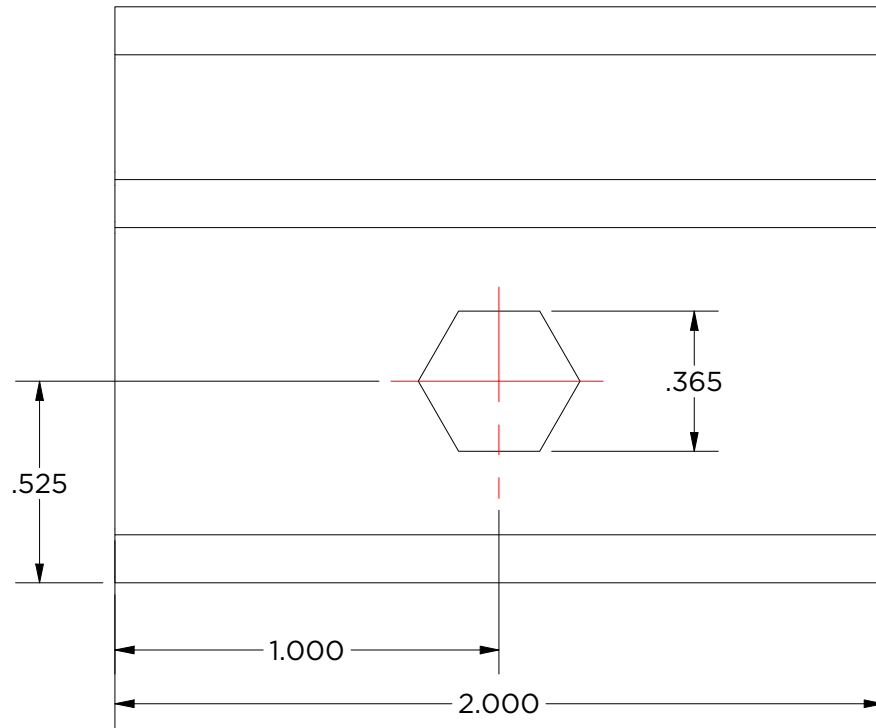
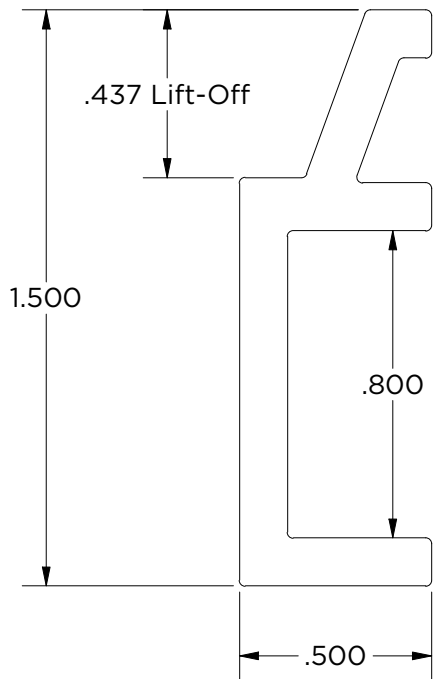

Created By: AMH	Approved By: AMH	Sheet Size A	Sheet No. 3/9
Creation Date: 9/27/2022	Approval Date: 9/27/2022	Scale 2 : 1	Rev

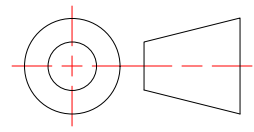

MFSTR-050-2-K

Heavy Duty 1/2" Clip for Kiel Anchors

Weight: 0.056 lbmass
Aluminum 6063
Finish: Mill Finish



MONARCH
METAL INC.

PROPRIETARY AND CONFIDENTIAL

THE INFORMATION CONTAINED IN THIS DRAWING IS THE SOLE PROPERTY OF MONARCH METAL FABRICATION. ANY REPRODUCTION IN PART OR AS A WHOLE WITHOUT THE WRITTEN PERMISSION OF MONARCH METAL INC. IS PROHIBITED.

New York
1700 Ocean Ave Suite 2
Ronkonkoma NY 11779
Phone: (631) 750-3000

Nevada
1080 Linda Way, Unit 10
Sparks, NV 89431
Phone: (775) 415-0100

Texas
1330 Post & Paddock St.,
Suite 800
Grand Prairie, TX 75050
(945) 202-2700

monarchmetal.com

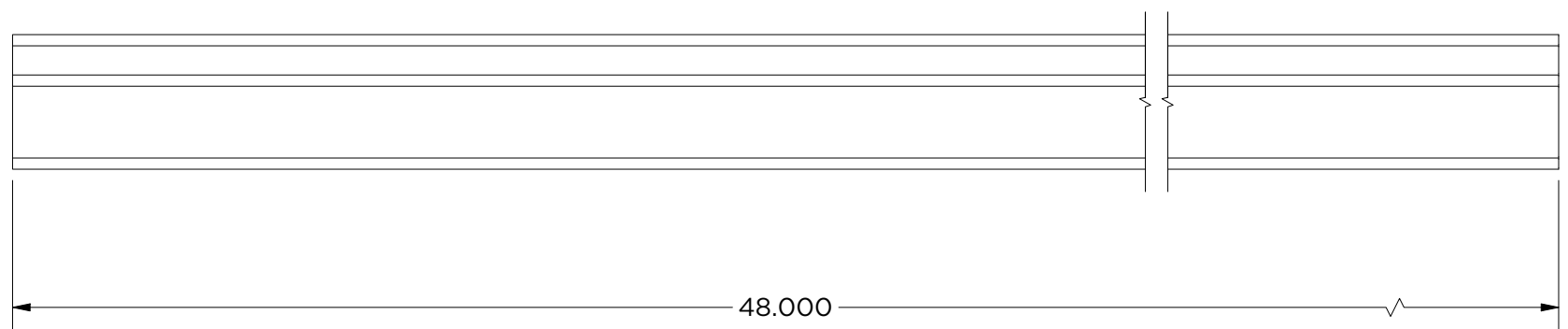
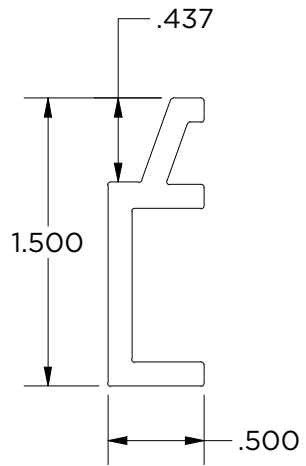

Created By: AMH	Approved By: AMH	Sheet Size A	Sheet No. 4/9
Creation Date: 9/27/2022	Approval Date: 9/27/2022	Scale 1:1	Rev

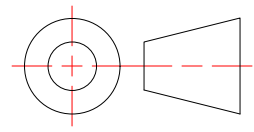

MFSTR-050-2
Heavy Duty 1/2" Clip

Weight: 1.378 lbmass
Aluminum 6063
Finish: Mill Finish



MONARCH
METAL INC.

PROPRIETARY AND CONFIDENTIAL
THE INFORMATION CONTAINED IN THIS DRAWING IS THE SOLE PROPERTY OF MONARCH METAL FABRICATION. ANY REPRODUCTION IN PART OR AS A WHOLE WITHOUT THE WRITTEN PERMISSION OF MONARCH METAL INC. IS PROHIBITED.

New York 1700 Ocean Ave Suite 2 Ronkonkoma NY 11779 Phone: (631) 750-3000	Nevada 1080 Linda Way, Unit 10 Sparks, NV 89431 Phone: (775) 415-0100	Texas 1330 Post & Paddock St., Suite 800 Grand Prairie, TX 75050 (945) 202-2700
---	---	--

monarchmetal.com

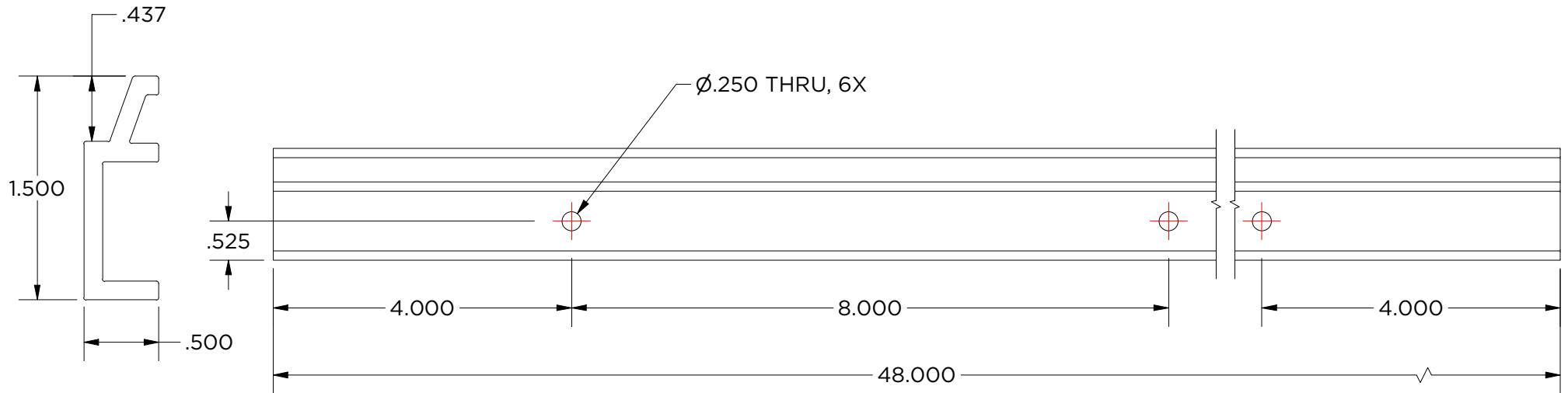

Created By: AMH	Approved By: AMH	Sheet Size A	Sheet No. 5/9
Creation Date: 9/27/2022	Approval Date: 9/27/2022	Scale 1:1	Rev

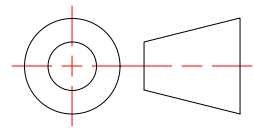

MFSTR-050-48H8
Heavy Duty 1/2" Rail

Weight: 1.374 lbmass
Aluminum 6063
Finish: Mill Finish



MONARCH
METAL INC.

PROPRIETARY AND CONFIDENTIAL
THE INFORMATION CONTAINED IN THIS DRAWING IS THE SOLE PROPERTY OF MONARCH METAL FABRICATION. ANY REPRODUCTION IN PART OR AS A WHOLE WITHOUT THE WRITTEN PERMISSION OF MONARCH METAL INC. IS PROHIBITED.

New York 1700 Ocean Ave Suite 2 Ronkonkoma NY 11779 Phone: (631) 750-3000	Nevada 1080 Linda Way, Unit 10 Sparks, NV 89431 Phone: (775) 415-0100	Texas 1330 Post & Paddock St., Suite 800 Grand Prairie, TX 75050 (945) 202-2700
---	---	--

monarchmetal.com

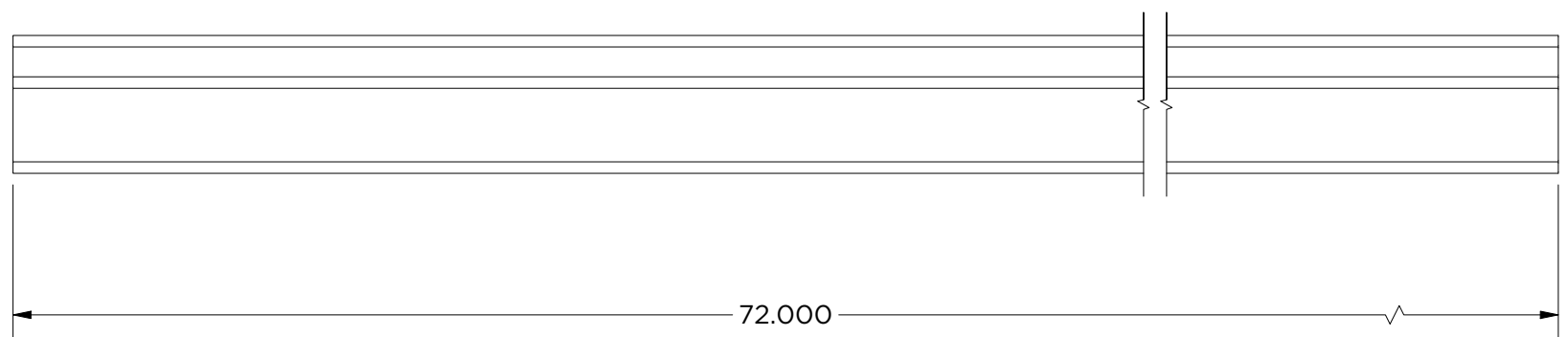
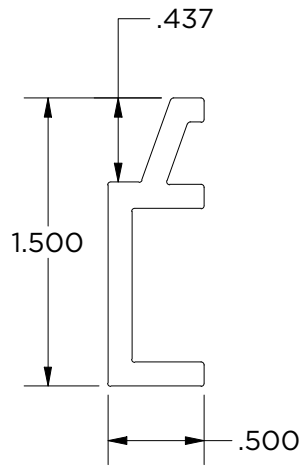

Created By: AMH	Approved By: AMH	Sheet Size A	Sheet No. 6/9
Creation Date: 9/27/2022	Approval Date: 9/27/2022	Scale 1:1	Rev

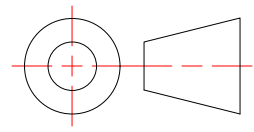

MFSTR-050-72
Heavy Duty 1/2" Rail

Weight: 2.066 lbmass
Aluminum 6063
Finish: Mill Finish



MONARCH
METAL INC.

PROPRIETARY AND CONFIDENTIAL
THE INFORMATION CONTAINED IN THIS DRAWING IS THE SOLE PROPERTY OF MONARCH METAL FABRICATION. ANY REPRODUCTION IN PART OR AS A WHOLE WITHOUT THE WRITTEN PERMISSION OF MONARCH METAL INC. IS PROHIBITED.

New York 1700 Ocean Ave Suite 2 Ronkonkoma NY 11779 Phone: (631) 750-3000	Nevada 1080 Linda Way, Unit 10 Sparks, NV 89431 Phone: (775) 415-0100	Texas 1330 Post & Paddock St., Suite 800 Grand Prairie, TX 75050 (945) 202-2700
---	---	--

monarchmetal.com

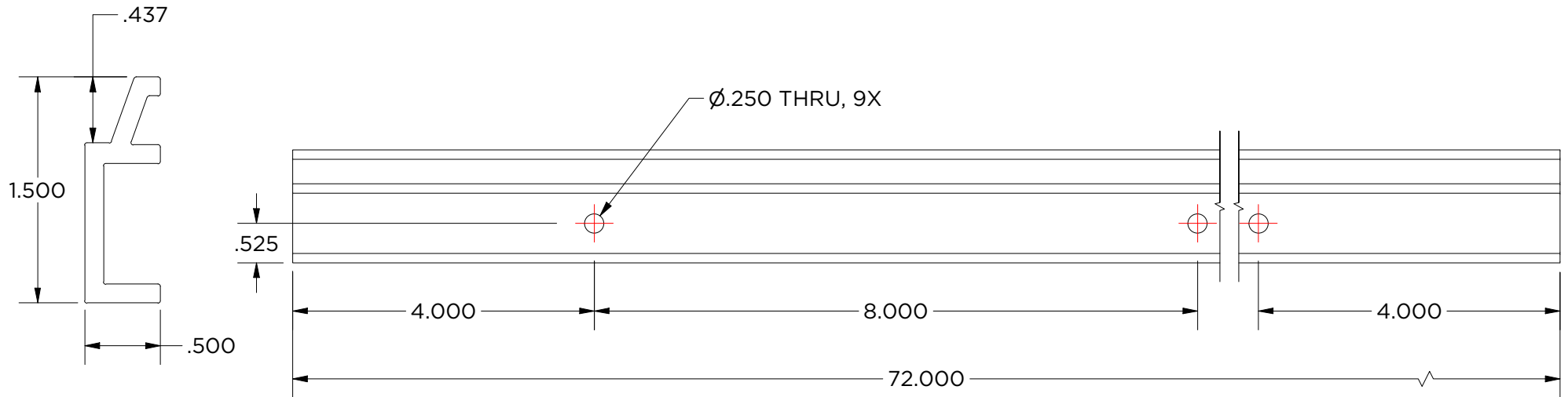

Created By: AMH	Approved By: AMH	Sheet Size A	Sheet No. 7/9
Creation Date: 9/27/2022	Approval Date: 9/27/2022	Scale 1:1	Rev

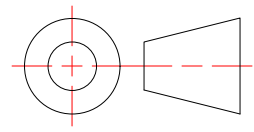

MFSTR-050-72H8
Heavy Duty 1/2" Rail

Weight: 2.061 lbmass
Aluminum 6063
Finish: Mill Finish



MONARCH
METAL INC.

PROPRIETARY AND CONFIDENTIAL
THE INFORMATION CONTAINED IN THIS DRAWING IS THE SOLE PROPERTY OF MONARCH METAL FABRICATION. ANY REPRODUCTION IN PART OR AS A WHOLE WITHOUT THE WRITTEN PERMISSION OF MONARCH METAL INC. IS PROHIBITED.

New York 1700 Ocean Ave Suite 2 Ronkonkoma NY 11779 Phone: (631) 750-3000	Nevada 1080 Linda Way, Unit 10 Sparks, NV 89431 Phone: (775) 415-0100	Texas 1330 Post & Paddock St., Suite 800 Grand Prairie, TX 75050 (945) 202-2700
---	---	--

monarchmetal.com

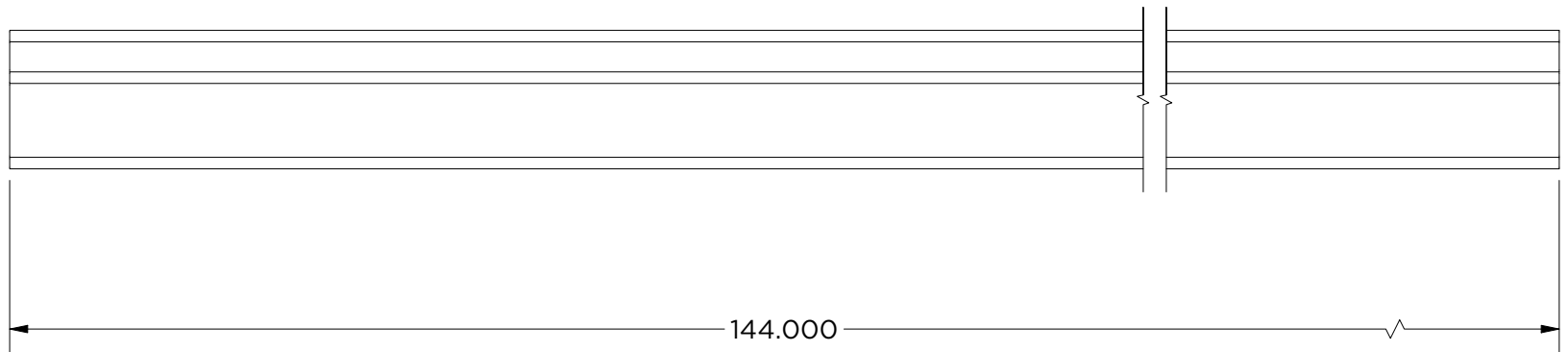
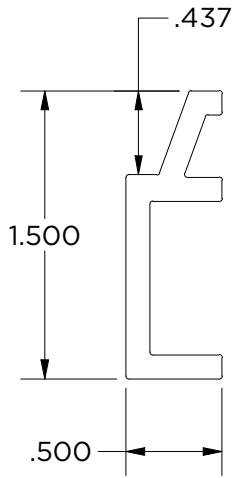

Created By: AMH	Approved By: AMH	Sheet Size A	Sheet No. 8/9
Creation Date: 9/27/2022	Approval Date: 9/27/2022	Scale 1:1	Rev

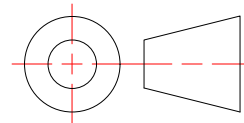

MFSTR-050-144
Heavy Duty 1/2" Rail

Weight: 4.133 lbmass
Aluminum 6063
Finish: Mill Finish



MONARCH
METAL INC.

PROPRIETARY AND CONFIDENTIAL

THE INFORMATION CONTAINED IN THIS DRAWING IS THE SOLE PROPERTY OF MONARCH METAL FABRICATION. ANY REPRODUCTION IN PART OR AS A WHOLE WITHOUT THE WRITTEN PERMISSION OF MONARCH METAL INC. IS PROHIBITED.

New York
1700 Ocean Ave Suite 2
Ronkonkoma NY 11779
Phone: (631) 750-3000

Nevada
1080 Linda Way, Unit 10
Sparks, NV 89431
Phone: (775) 415-0100

Texas
1330 Post & Paddock St.,
Suite 800
Grand Prairie, TX 75050
(945) 202-2700

monarchmetal.com

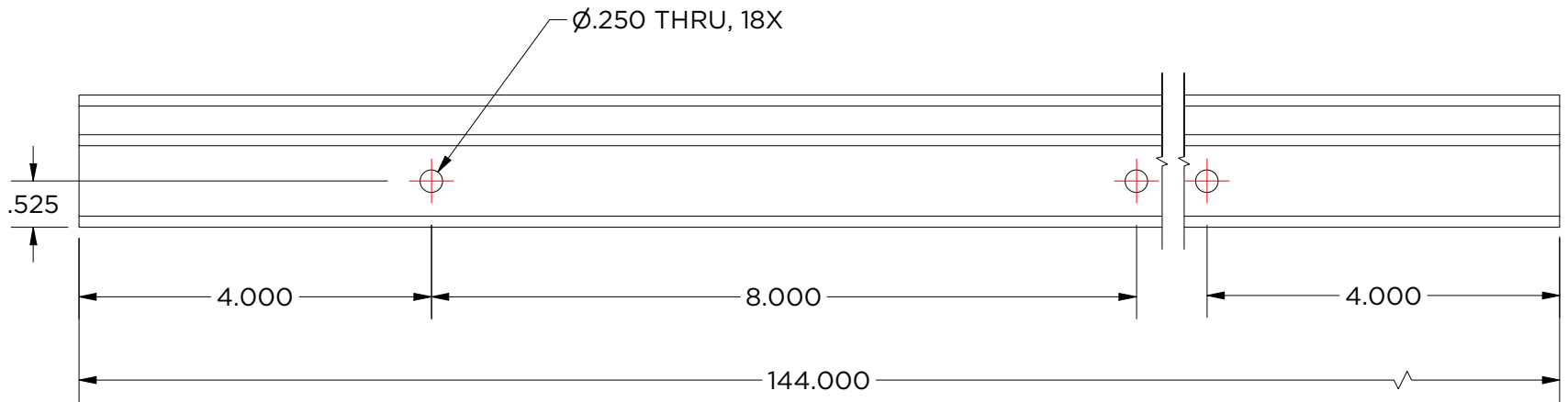
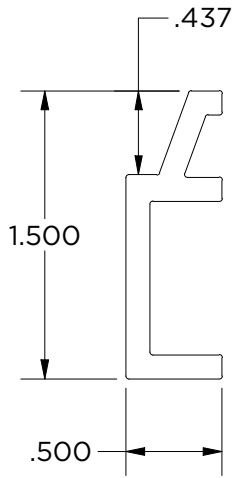

Created By: AMH	Approved By: AMH	Sheet Size A	Sheet No. 9/9
Creation Date: 9/27/2022	Approval Date: 9/27/2022	Scale 1:1	Rev

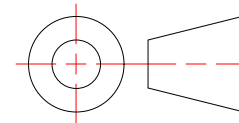

MFSTR-050-144H8

Heavy Duty 1/2" Rail

Weight: 4.122 lbmass

Aluminum 6063

Finish: Mill Finish



MONARCH
METAL INC.

PROPRIETARY AND CONFIDENTIAL

THE INFORMATION CONTAINED IN THIS DRAWING IS THE SOLE PROPERTY OF MONARCH METAL FABRICATION. ANY REPRODUCTION IN PART OR AS A WHOLE WITHOUT THE WRITTEN PERMISSION OF MONARCH METAL INC. IS PROHIBITED.

New York
1700 Ocean Ave Suite 2
Ronkonkoma NY 11779
Phone: (631) 750-3000

Nevada
1080 Linda Way, Unit 10
Sparks, NV 89431
Phone: (775) 415-0100

Texas
1330 Post & Paddock St.,
Suite 800
Grand Prairie, TX 75050
(945) 202-2700

monarchmetal.com