

<b>Created By:</b> amh	<b>Approved By:</b>	<b>Sheet Size</b> A	<b>Sheet No.</b> 1/5
<b>Creation Date:</b> 1/9/2025	<b>Approval Date:</b>	<b>Scale</b> 1:1	<b>Rev</b>

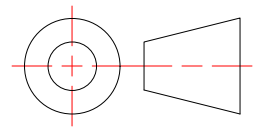

**MFTAPE-S Assy**

Typical MFTAPE-S Installation, (1) MF375 Wall Rail, (1) MFTAPE-S Clip Shown

Weight: 1.737 lbmass

Finish: Mill



**MONARCH**  
METAL INC.

**PROPRIETARY AND CONFIDENTIAL**

THE INFORMATION CONTAINED IN THIS DRAWING IS THE SOLE PROPERTY OF MONARCH METAL FABRICATION. ANY REPRODUCTION IN PART OR AS A WHOLE WITHOUT THE WRITTEN PERMISSION OF MONARCH METAL INC. IS PROHIBITED.

**New York**  
1700 Ocean Ave Suite 2  
Ronkonkoma NY 11779  
Phone: (631) 750-3000

**Nevada**  
1080 Linda Way, Unit 10  
Sparks, NV 89431  
Phone: (775) 415-0100

**Texas**  
1330 Post & Paddock St.,  
Suite 800  
Grand Prairie, TX 75050  
(945) 202-2700

monarchmetal.com

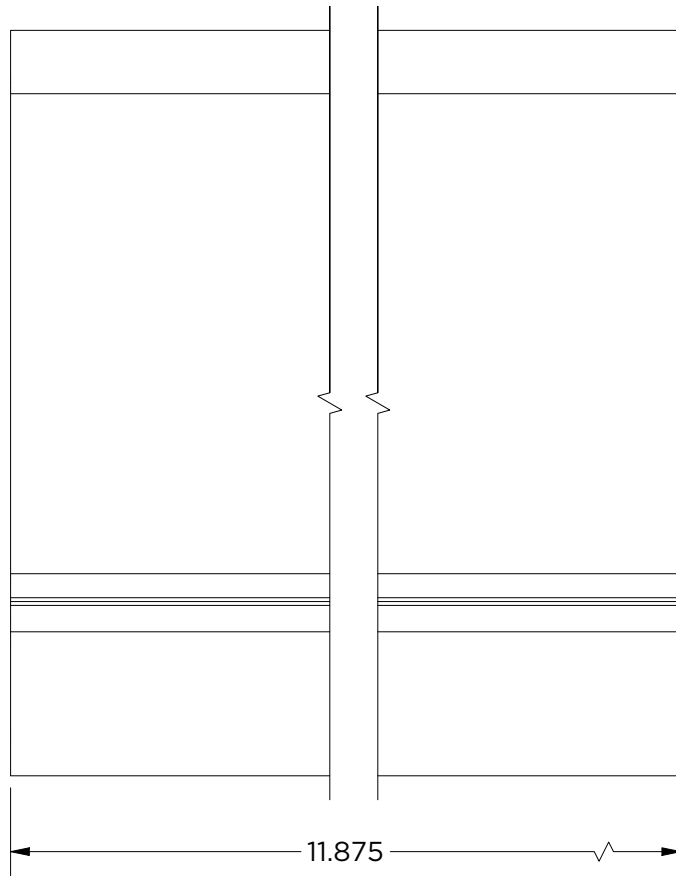
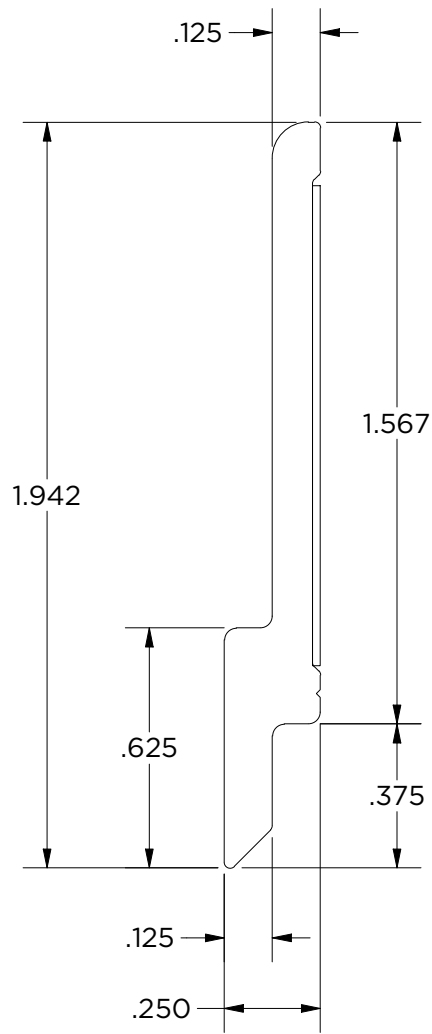

<b>Created By:</b> amh	<b>Approved By:</b>	<b>Sheet Size</b> A	<b>Sheet No.</b> 2/5
<b>Creation Date:</b> 1/9/2025	<b>Approval Date:</b>	<b>Scale</b> 2 : 1	<b>Rev</b>

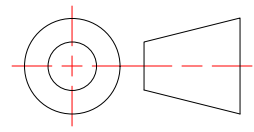

**MFTAPE-S-11.875**

Weight: 0.279 lbmass

Finish: Mill



**MONARCH**  
METAL INC.

**PROPRIETARY AND CONFIDENTIAL**

THE INFORMATION CONTAINED IN THIS DRAWING IS THE SOLE PROPERTY OF MONARCH METAL FABRICATION. ANY REPRODUCTION IN PART OR AS A WHOLE WITHOUT THE WRITTEN PERMISSION OF MONARCH METAL INC. IS PROHIBITED.

**New York**  
1700 Ocean Ave Suite 2  
Ronkonkoma NY 11779  
Phone: (631) 750-3000

**Nevada**  
1080 Linda Way, Unit 10  
Sparks, NV 89431  
Phone: (775) 415-0100

**Texas**  
1330 Post & Paddock St.,  
Suite 800  
Grand Prairie, TX 75050  
(945) 202-2700

monarchmetal.com

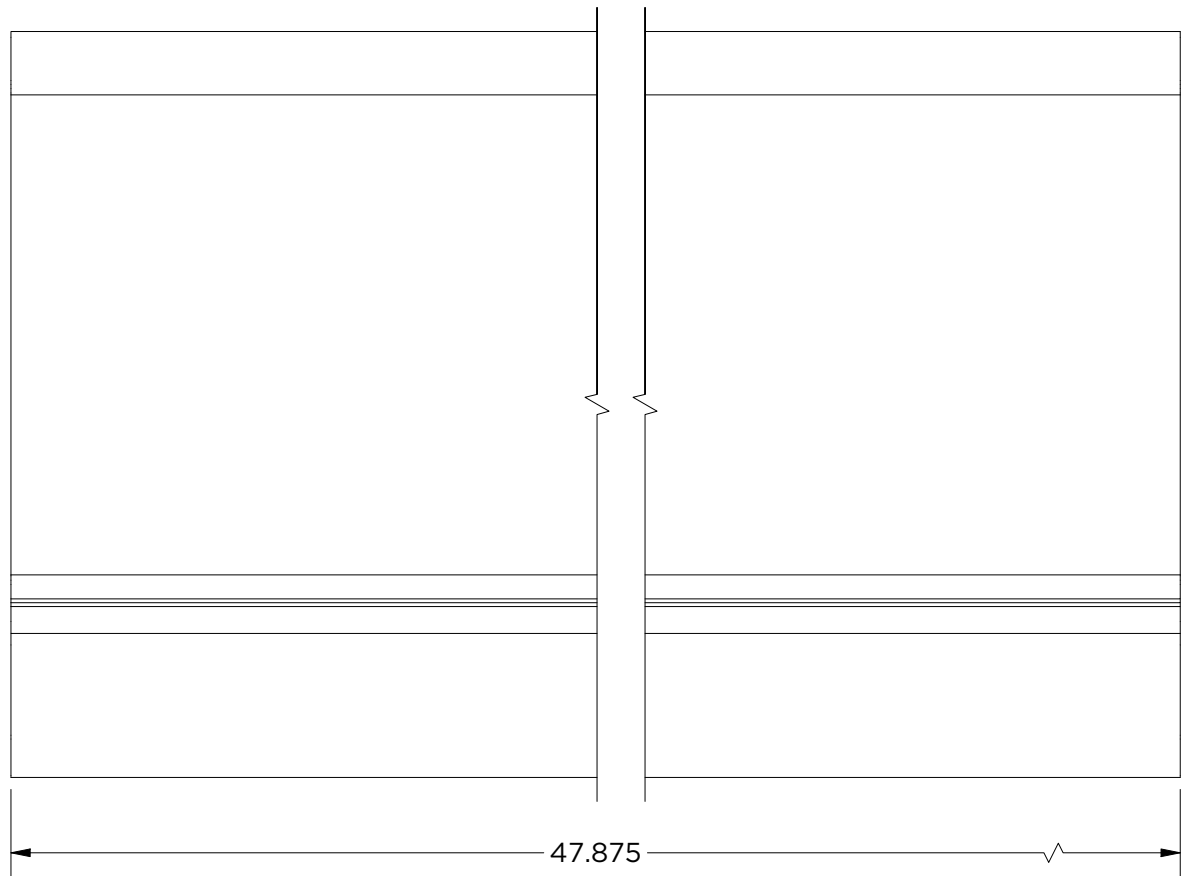
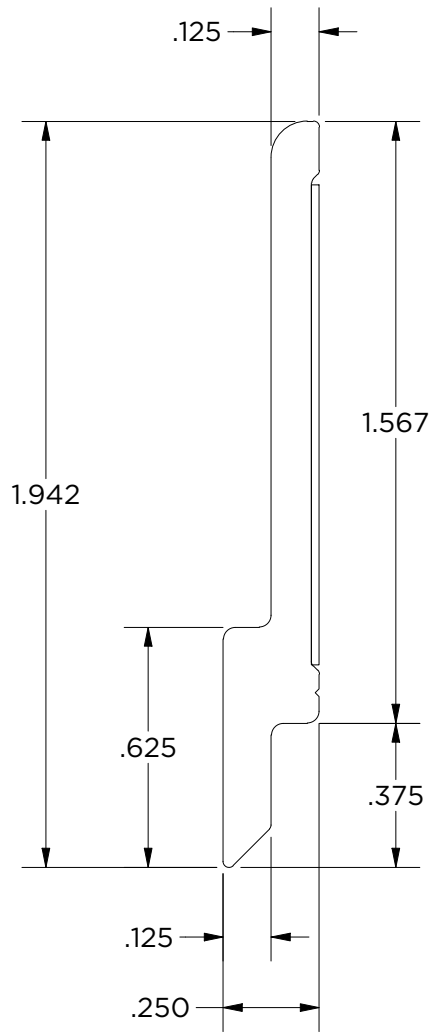

<b>Created By:</b> amh	<b>Approved By:</b>	<b>Sheet Size</b> A	<b>Sheet No.</b> 3/5
<b>Creation Date:</b> 1/9/2025	<b>Approval Date:</b>	<b>Scale</b> 2 : 1	<b>Rev</b>

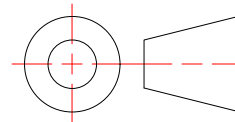

**MFTAPE-S-48**

Weight: 1.127 lbmass

Finish: Mill



**MONARCH**  
METAL INC.

**PROPRIETARY AND CONFIDENTIAL**

THE INFORMATION CONTAINED IN THIS DRAWING IS THE SOLE PROPERTY OF MONARCH METAL FABRICATION. ANY REPRODUCTION IN PART OR AS A WHOLE WITHOUT THE WRITTEN PERMISSION OF MONARCH METAL INC. IS PROHIBITED.

**New York**  
1700 Ocean Ave Suite 2  
Ronkonkoma NY 11779  
Phone: (631) 750-3000

**Nevada**  
1080 Linda Way, Unit 10  
Sparks, NV 89431  
Phone: (775) 415-0100

**Texas**  
1330 Post & Paddock St.,  
Suite 800  
Grand Prairie, TX 75050  
(945) 202-2700

monarchmetal.com

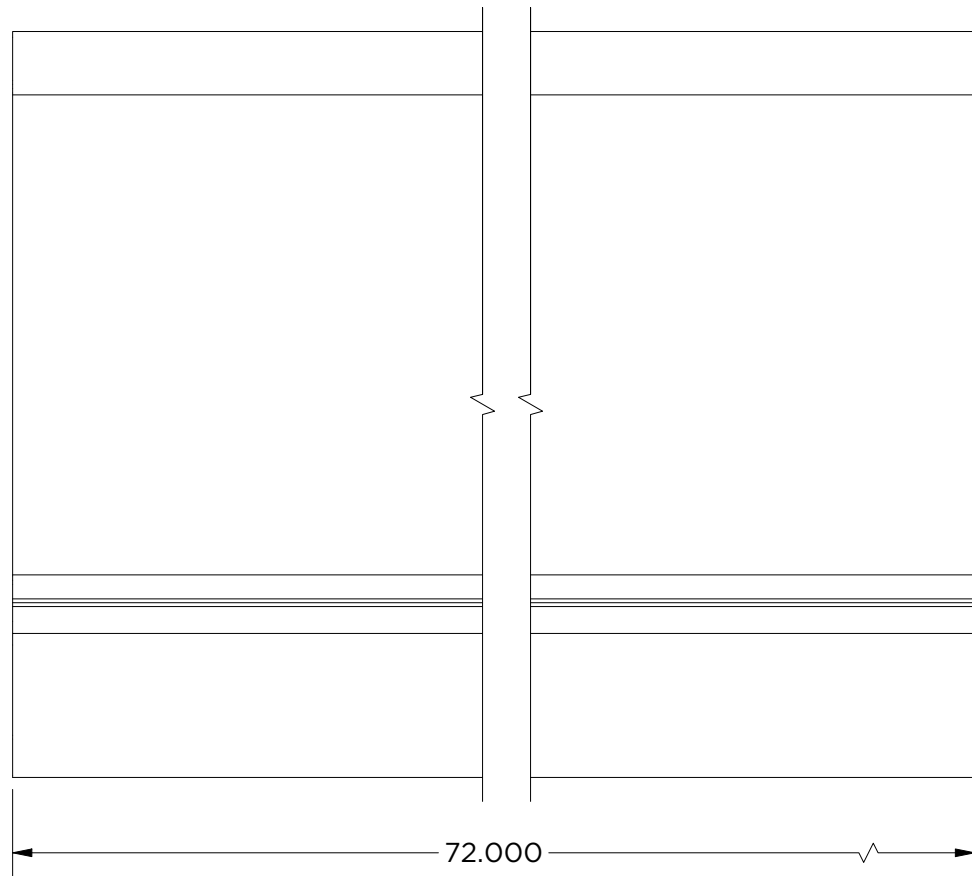
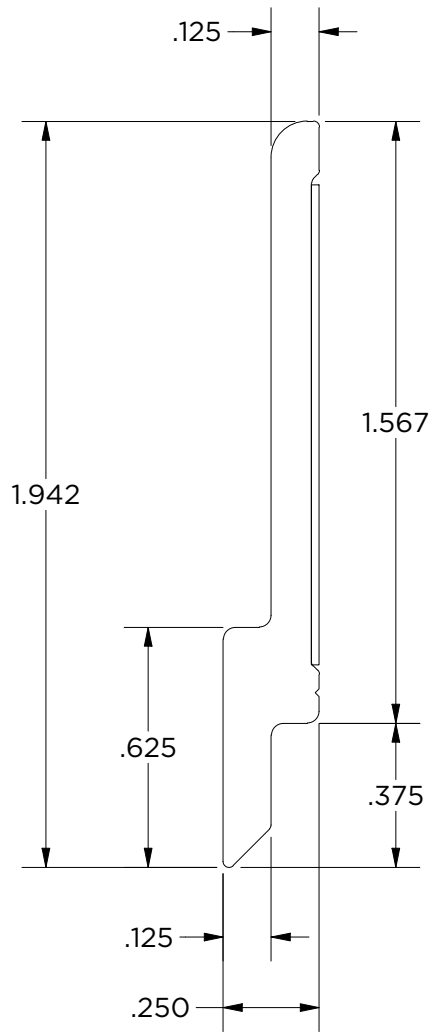

<b>Created By:</b> amh	<b>Approved By:</b>	<b>Sheet Size</b> A	<b>Sheet No.</b> 4/5
<b>Creation Date:</b> 1/9/2025	<b>Approval Date:</b>	<b>Scale</b> 2 : 1	<b>Rev</b>

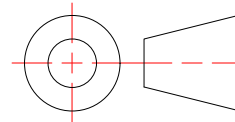

**MFTAPE-S-72**

Weight: 1.695 lbmass

Finish: Mill



**MONARCH**  
METAL INC.

**PROPRIETARY AND CONFIDENTIAL**

THE INFORMATION CONTAINED IN THIS DRAWING IS THE SOLE PROPERTY OF MONARCH METAL FABRICATION. ANY REPRODUCTION IN PART OR AS A WHOLE WITHOUT THE WRITTEN PERMISSION OF MONARCH METAL INC. IS PROHIBITED.

**New York**  
1700 Ocean Ave Suite 2  
Ronkonkoma NY 11779  
Phone: (631) 750-3000

**Nevada**  
1080 Linda Way, Unit 10  
Sparks, NV 89431  
Phone: (775) 415-0100

**Texas**  
1330 Post & Paddock St.,  
Suite 800  
Grand Prairie, TX 75050  
(945) 202-2700

monarchmetal.com

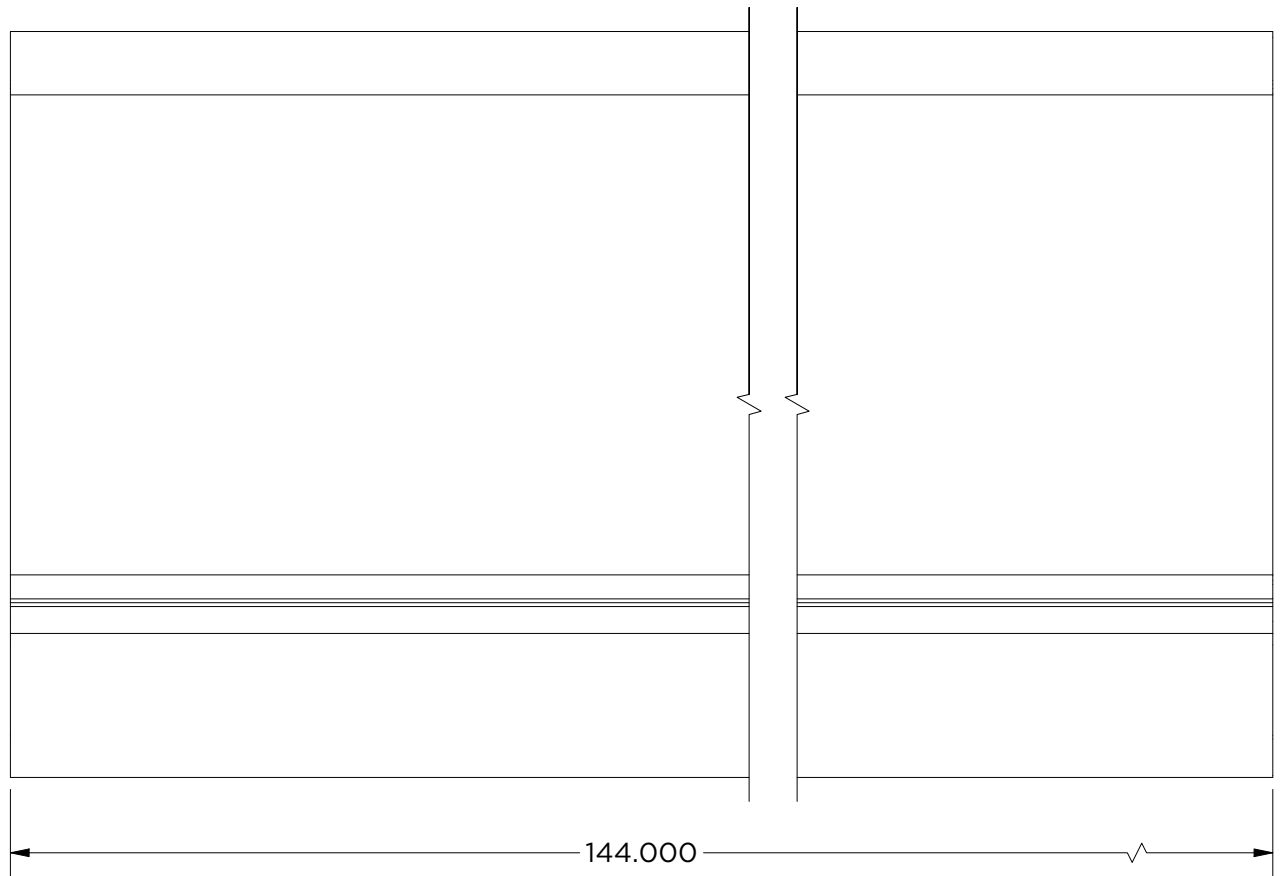
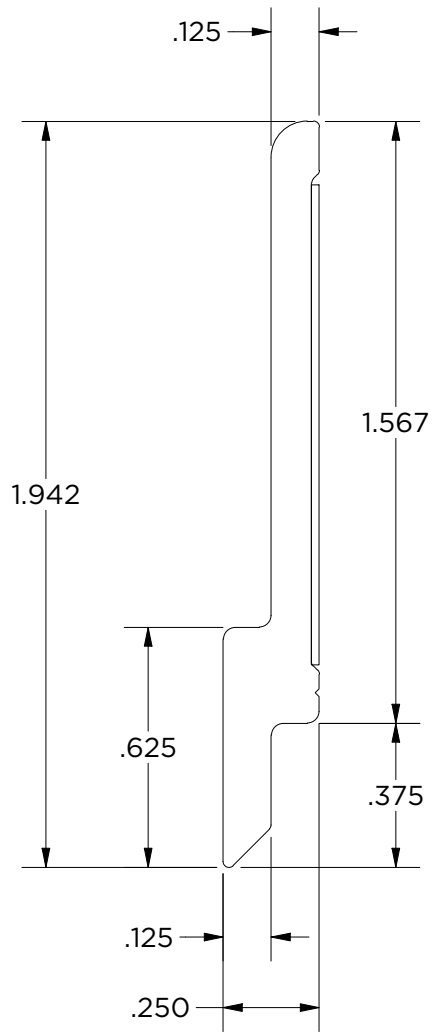

<b>Created By:</b> amh	<b>Approved By:</b>	<b>Sheet Size</b> A	<b>Sheet No.</b> 5/5
<b>Creation Date:</b> 1/9/2025	<b>Approval Date:</b>	<b>Scale</b> 2 : 1	<b>Rev</b>

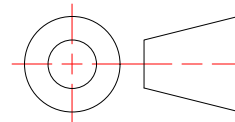

**MFTAPE-S-144**

Weight: 3.389 lbmass

Finish: Mill



**MONARCH**  
METAL INC.

**PROPRIETARY AND CONFIDENTIAL**

THE INFORMATION CONTAINED IN THIS DRAWING IS THE SOLE PROPERTY OF MONARCH METAL FABRICATION. ANY REPRODUCTION IN PART OR AS A WHOLE WITHOUT THE WRITTEN PERMISSION OF MONARCH METAL INC. IS PROHIBITED.

**New York**  
1700 Ocean Ave Suite 2  
Ronkonkoma NY 11779  
Phone: (631) 750-3000

**Nevada**  
1080 Linda Way, Unit 10  
Sparks, NV 89431  
Phone: (775) 415-0100

**Texas**  
1330 Post & Paddock St.,  
Suite 800  
Grand Prairie, TX 75050  
(945) 202-2700

monarchmetal.com