

MCPS-CR-48, 72, 144

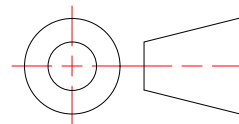

MCPS-PR-48, 72, 144 , MCPS-PC-6

Created By: amh	Approved By:	Sheet Size A	Sheet No. 1/8
Creation Date: 7/2/2025	Approval Date:	Scale 2 : 1	Rev



MCPS-CR-144

Ceiling System Ceiling Rail

Weight: 2.527 lbmass
Aluminum 6063-T6
Finish: Mill



MONARCH
METAL INC.

PROPRIETARY AND CONFIDENTIAL

THE INFORMATION CONTAINED IN THIS DRAWING IS THE SOLE PROPERTY OF MONARCH METAL FABRICATION. ANY REPRODUCTION IN PART OR AS A WHOLE WITHOUT THE WRITTEN PERMISSION OF MONARCH METAL INC. IS PROHIBITED.

New York
1700 Ocean Ave Suite 2
Ronkonkoma NY 11779
Phone: (631) 750-3000

Nevada
1080 Linda Way, Unit 10
Sparks, NV 89431
Phone: (775) 415-0100

Texas
1330 Post & Paddock St.,
Suite 800
Grand Prairie, TX 75050
(945) 202-2700

monarchmetal.com

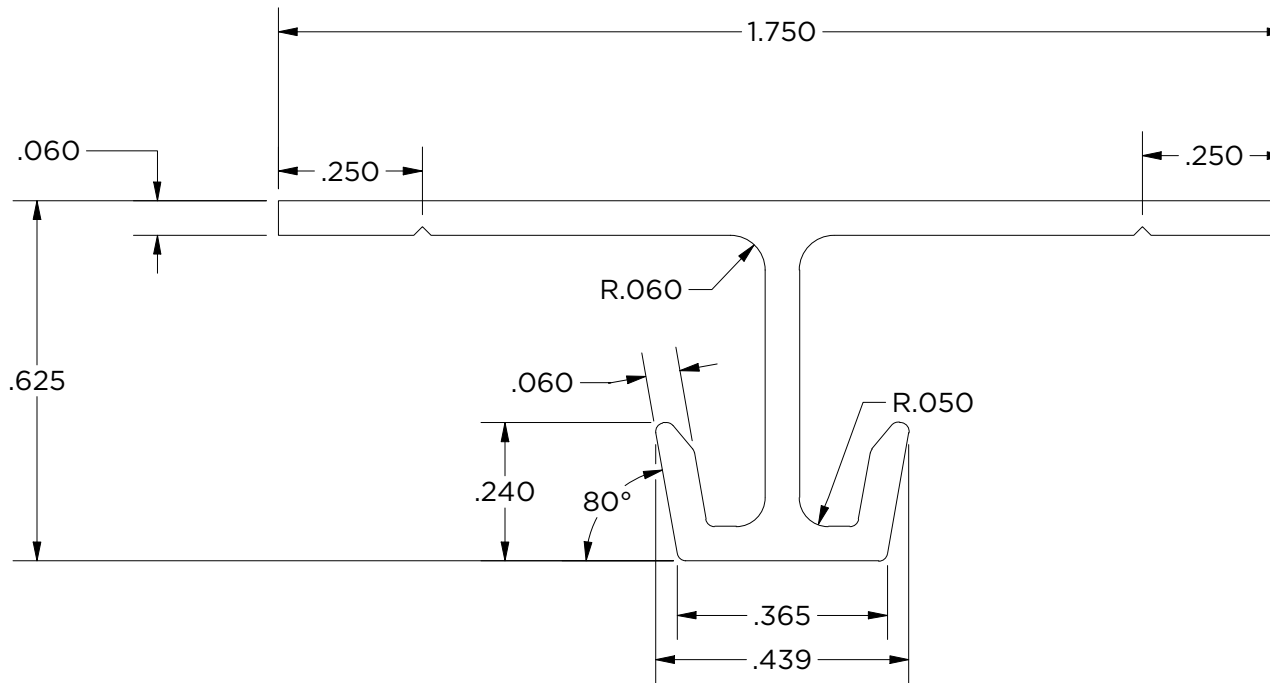
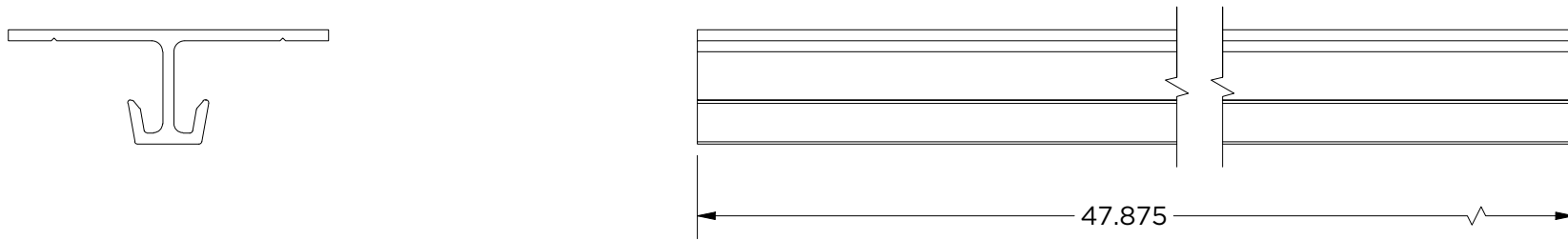

Created By: amh	Approved By:	Sheet Size A	Sheet No. 2/8
Creation Date: 7/2/2025	Approval Date:	Scale 3 : 1	Rev

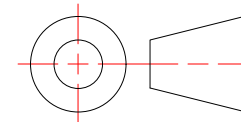

MCPS-CR-48
Ceiling System Ceiling Rail

Weight: 0.840 lbmass
Aluminum 6063-T6
Finish: Mill



MONARCH
METAL INC.

PROPRIETARY AND CONFIDENTIAL

THE INFORMATION CONTAINED IN THIS DRAWING IS THE SOLE PROPERTY OF MONARCH METAL FABRICATION. ANY REPRODUCTION IN PART OR AS A WHOLE WITHOUT THE WRITTEN PERMISSION OF MONARCH METAL INC. IS PROHIBITED.

New York
1700 Ocean Ave Suite 2
Ronkonkoma NY 11779
Phone: (631) 750-3000

Nevada
1080 Linda Way, Unit 10
Sparks, NV 89431
Phone: (775) 415-0100

Texas
1330 Post & Paddock St.,
Suite 800
Grand Prairie, TX 75050
(945) 202-2700

monarchmetal.com

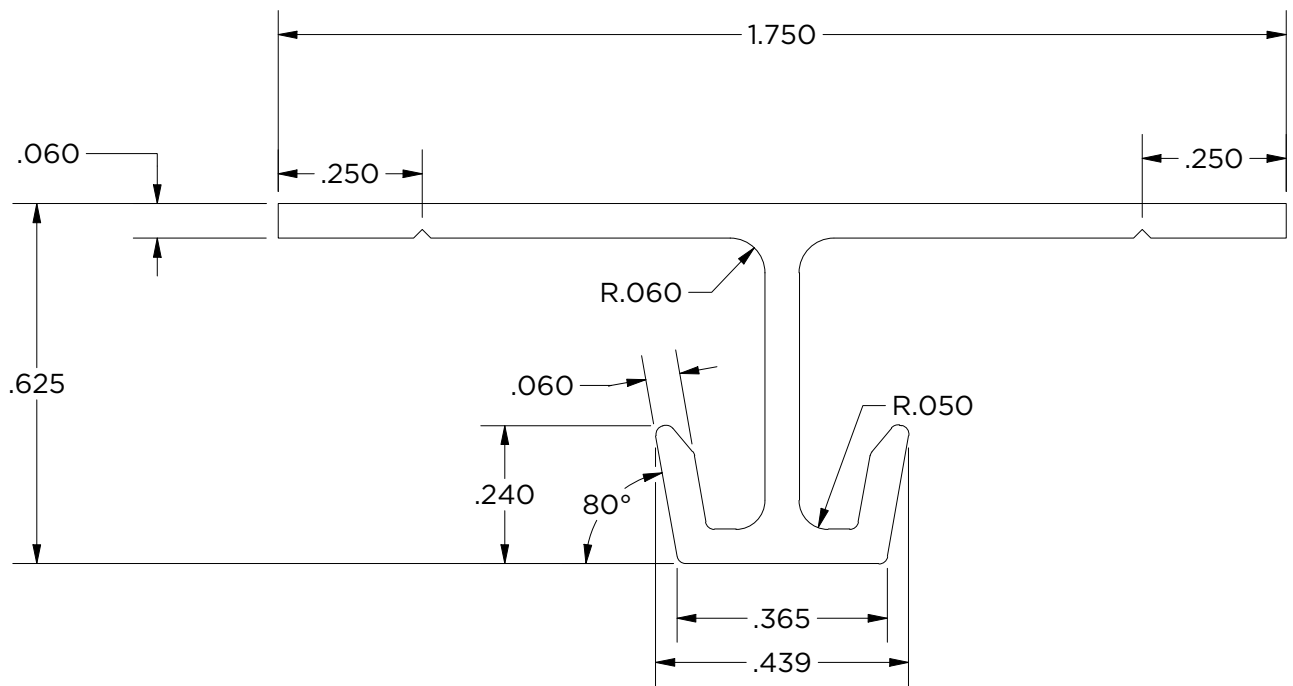
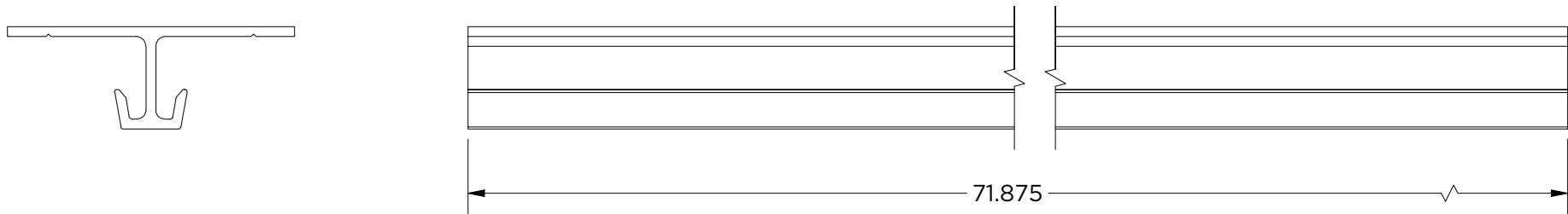

Created By: amh	Approved By:	Sheet Size A	Sheet No. 3/8
Creation Date: 7/2/2025	Approval Date:	Scale 3 : 1	Rev

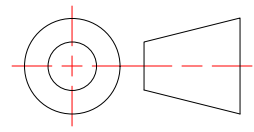

MCPS-CR-72

Ceiling System Ceiling Rail

Weight: 0.210 lbmass
 Aluminum 6063-T6
 Finish: Mill



MONARCH
METAL INC.

PROPRIETARY AND CONFIDENTIAL

THE INFORMATION CONTAINED IN THIS DRAWING IS THE SOLE PROPERTY OF MONARCH METAL FABRICATION. ANY REPRODUCTION IN PART OR AS A WHOLE WITHOUT THE WRITTEN PERMISSION OF MONARCH METAL INC. IS PROHIBITED.

New York
 1700 Ocean Ave Suite 2
 Ronkonkoma NY 11779
 Phone: (631) 750-3000

Nevada
 1080 Linda Way, Unit 10
 Sparks, NV 89431
 Phone: (775) 415-0100

Texas
 1330 Post & Paddock St.,
 Suite 800
 Grand Prairie, TX 75050
 (945) 202-2700

monarchmetal.com

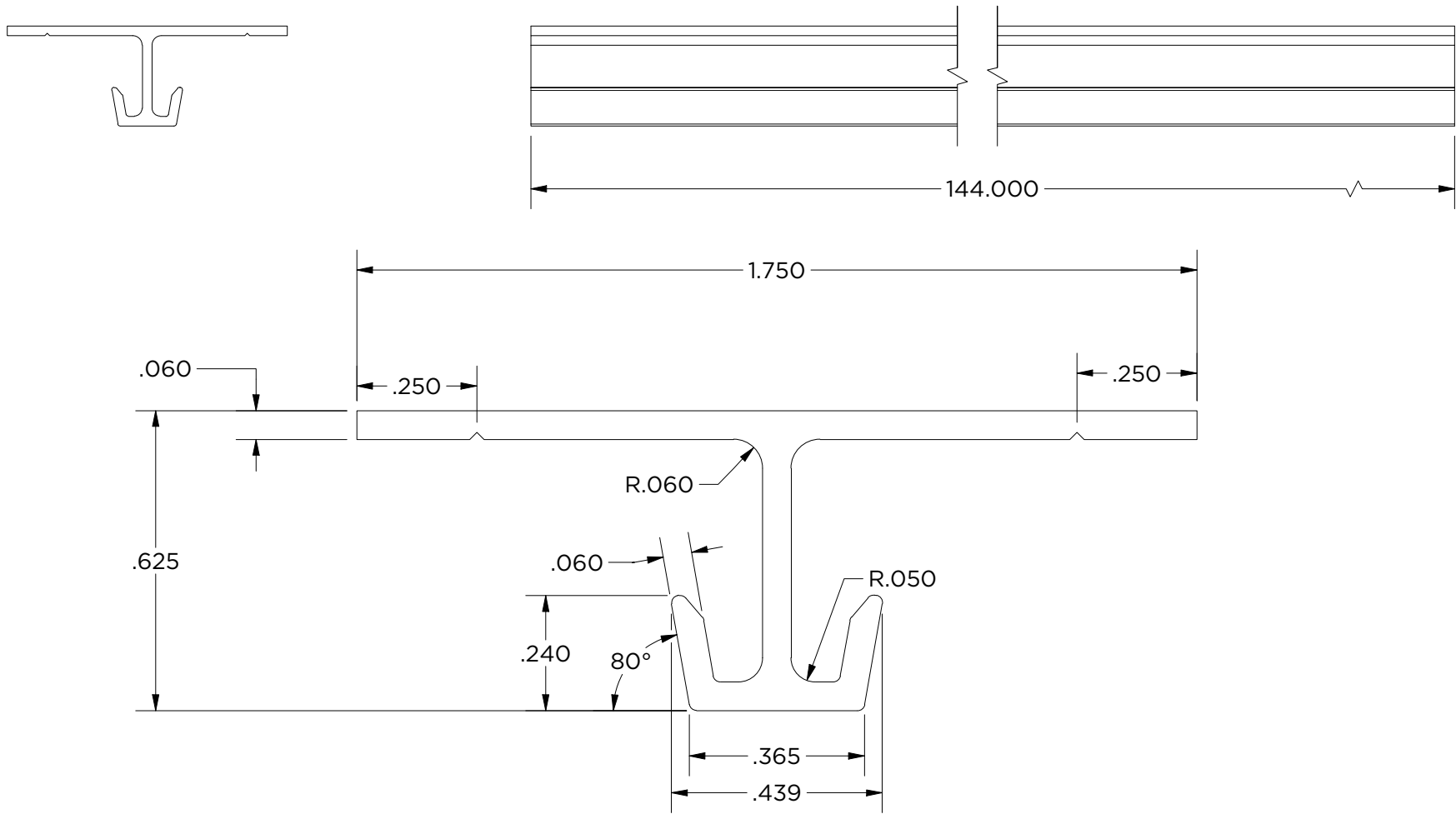

Created By: amh	Approved By:	Sheet Size A	Sheet No. 4/8
Creation Date: 7/2/2025	Approval Date:	Scale 3 : 1	Rev

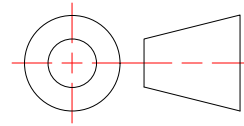

MCPS-CR-144

Ceiling System Ceiling Rail

Weight: 2.527 lbmass
Aluminum 6063-T6
Finish: Mill



MONARCH
METAL INC.

PROPRIETARY AND CONFIDENTIAL

THE INFORMATION CONTAINED IN THIS DRAWING IS THE SOLE PROPERTY OF MONARCH METAL FABRICATION. ANY REPRODUCTION IN PART OR AS A WHOLE WITHOUT THE WRITTEN PERMISSION OF MONARCH METAL INC. IS PROHIBITED.

New York
1700 Ocean Ave Suite 2
Ronkonkoma NY 11779
Phone: (631) 750-3000

Nevada
1080 Linda Way, Unit 10
Sparks, NV 89431
Phone: (775) 415-0100

Texas
1330 Post & Paddock St.,
Suite 800
Grand Prairie, TX 75050
(945) 202-2700

monarchmetal.com

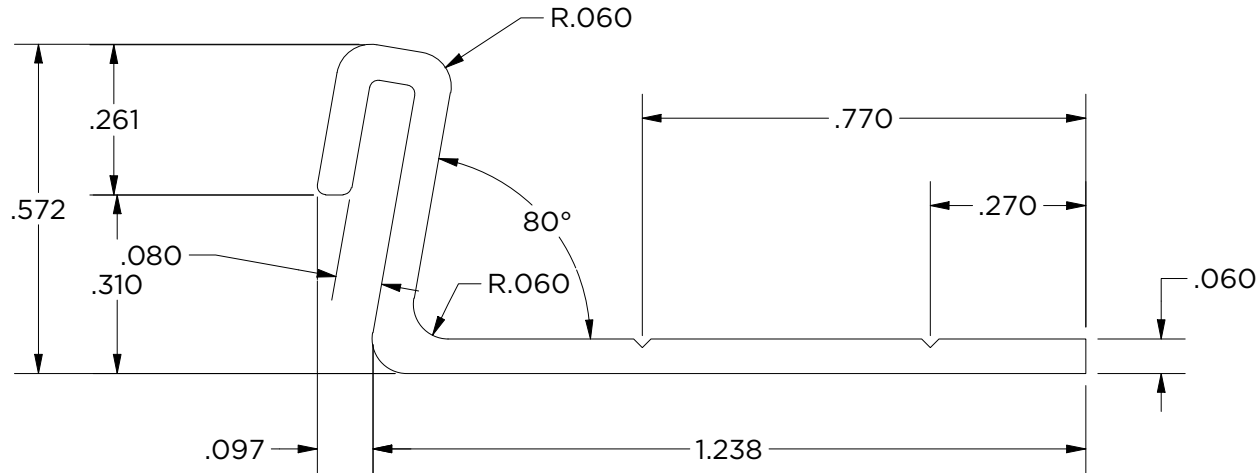
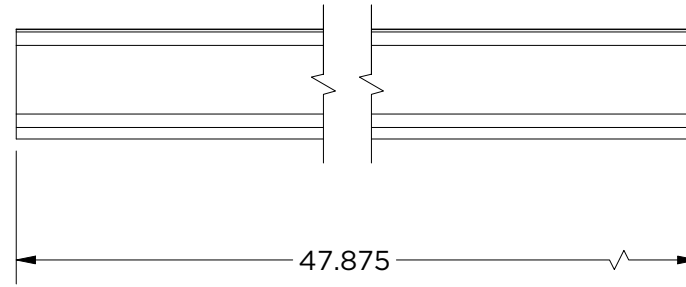
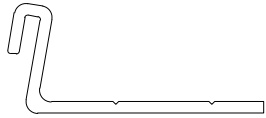

Created By: amh	Approved By:	Sheet Size A	Sheet No. 5/8
Creation Date: 7/2/2025	Approval Date:	Scale 3 : 1	Rev

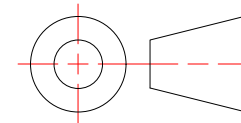

MCPS-PR-48
Ceiling System Panel Rail

Weight: 0.577 lbmass
Aluminum 6063-T6
Finish: Mill



MONARCH
METAL INC.

PROPRIETARY AND CONFIDENTIAL

THE INFORMATION CONTAINED IN THIS DRAWING IS THE SOLE PROPERTY OF MONARCH METAL FABRICATION. ANY REPRODUCTION IN PART OR AS A WHOLE WITHOUT THE WRITTEN PERMISSION OF MONARCH METAL INC. IS PROHIBITED.

New York
1700 Ocean Ave Suite 2
Ronkonkoma NY 11779
Phone: (631) 750-3000

Nevada
1080 Linda Way, Unit 10
Sparks, NV 89431
Phone: (775) 415-0100

Texas
1330 Post & Paddock St.,
Suite 800
Grand Prairie, TX 75050
(945) 202-2700

monarchmetal.com

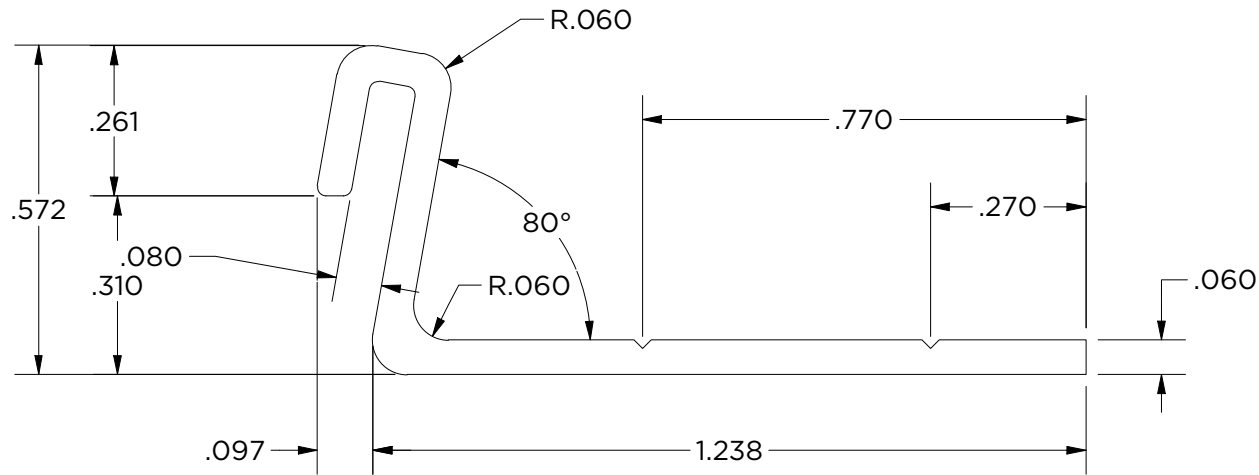
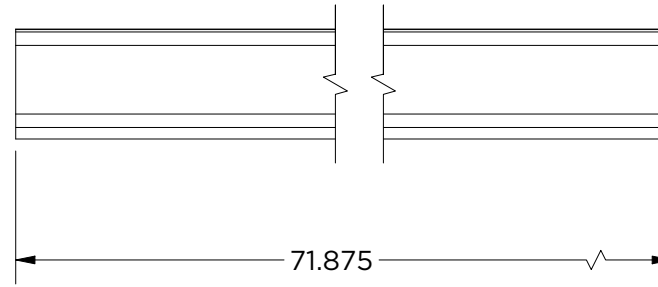
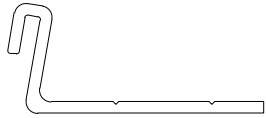

Created By: amh	Approved By:	Sheet Size A	Sheet No. 6/8
Creation Date: 7/2/2025	Approval Date:	Scale 3 : 1	Rev

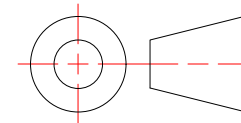

MCPS-PR-72
Ceiling System Panel Rail

Weight: 0.867 lbmass
Aluminum 6063-T6
Finish: Mill



MONARCH
METAL INC.

PROPRIETARY AND CONFIDENTIAL

THE INFORMATION CONTAINED IN THIS DRAWING IS THE SOLE PROPERTY OF MONARCH METAL FABRICATION. ANY REPRODUCTION IN PART OR AS A WHOLE WITHOUT THE WRITTEN PERMISSION OF MONARCH METAL INC. IS PROHIBITED.

New York
1700 Ocean Ave Suite 2
Ronkonkoma NY 11779
Phone: (631) 750-3000

Nevada
1080 Linda Way, Unit 10
Sparks, NV 89431
Phone: (775) 415-0100

Texas
1330 Post & Paddock St.,
Suite 800
Grand Prairie, TX 75050
(945) 202-2700

monarchmetal.com

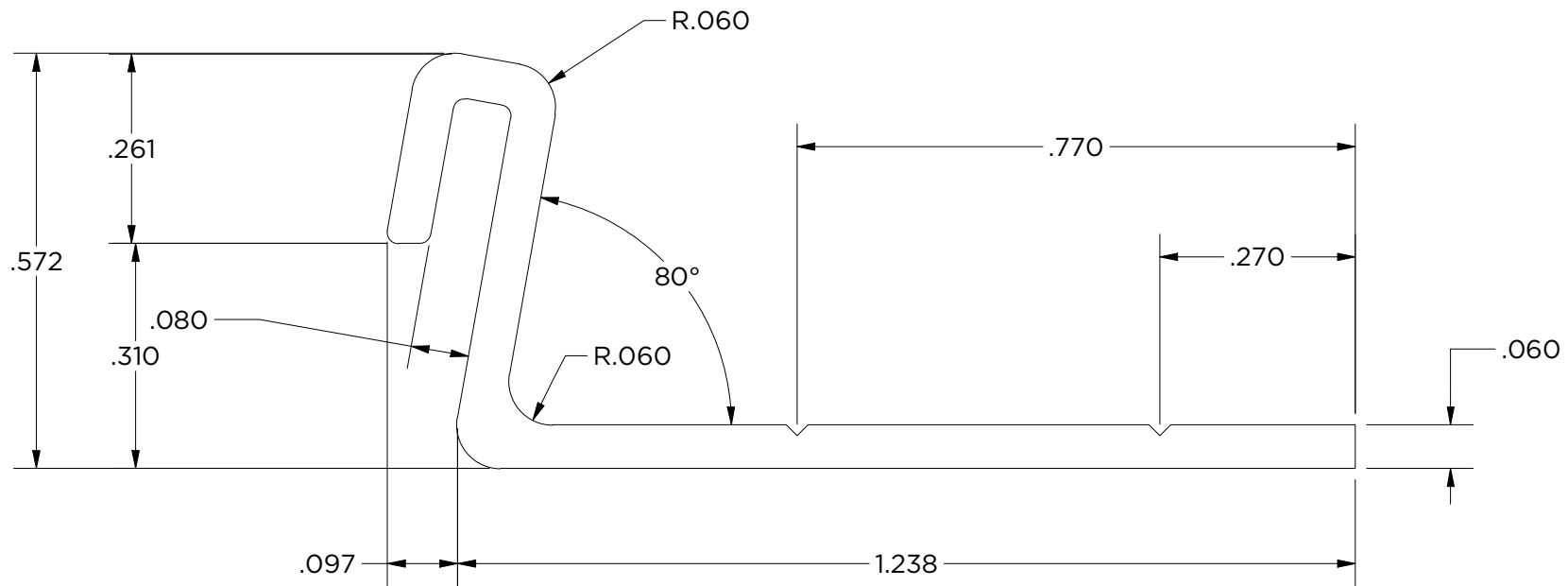
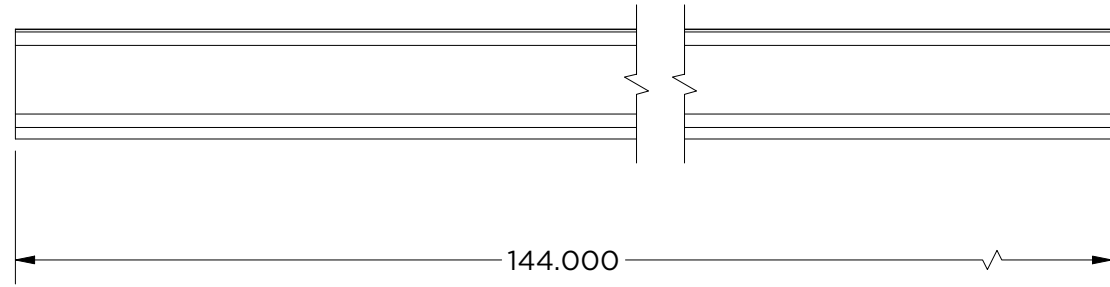

Created By: amh	Approved By:	Sheet Size A	Sheet No. 7/8
Creation Date: 7/2/2025	Approval Date:	Scale 4 : 1	Rev

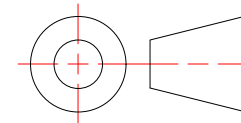

MCPS-PR-144
Ceiling System Panel Rail

Weight: 1.736 lbmass
Aluminum 6063-T6
Finish: Mill



MONARCH
METAL INC.

PROPRIETARY AND CONFIDENTIAL

THE INFORMATION CONTAINED IN THIS DRAWING IS THE SOLE PROPERTY OF MONARCH METAL FABRICATION. ANY REPRODUCTION IN PART OR AS A WHOLE WITHOUT THE WRITTEN PERMISSION OF MONARCH METAL INC. IS PROHIBITED.

New York
1700 Ocean Ave Suite 2
Ronkonkoma NY 11779
Phone: (631) 750-3000

Nevada
1080 Linda Way, Unit 10
Sparks, NV 89431
Phone: (775) 415-0100

Texas
1330 Post & Paddock St.,
Suite 800
Grand Prairie, TX 75050
(945) 202-2700

monarchmetal.com

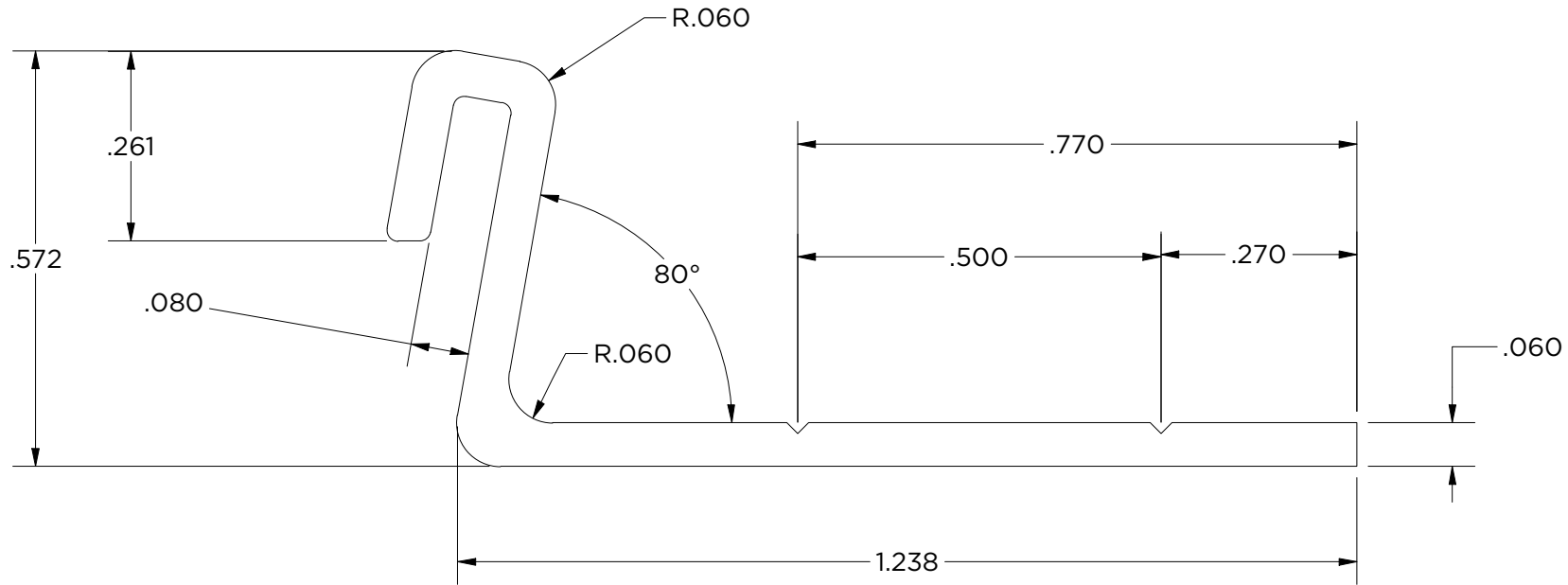
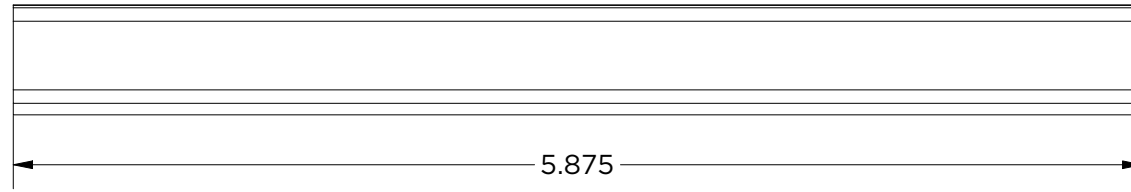

Created By: amh	Approved By:	Sheet Size A	Sheet No. 8/8
Creation Date: 7/2/2025	Approval Date:	Scale 4 : 1	Rev

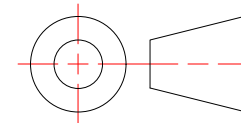

MCPS-PC-6
Ceiling System Panel Clip

Weight: 0.071 lbmass
Aluminum 6063-T6
Finish: Mill



MONARCH
METAL INC.

PROPRIETARY AND CONFIDENTIAL

THE INFORMATION CONTAINED IN THIS DRAWING IS THE SOLE PROPERTY OF MONARCH METAL FABRICATION. ANY REPRODUCTION IN PART OR AS A WHOLE WITHOUT THE WRITTEN PERMISSION OF MONARCH METAL INC. IS PROHIBITED.

New York
1700 Ocean Ave Suite 2
Ronkonkoma NY 11779
Phone: (631) 750-3000

Nevada
1080 Linda Way, Unit 10
Sparks, NV 89431
Phone: (775) 415-0100

Texas
1330 Post & Paddock St.,
Suite 800
Grand Prairie, TX 75050
(945) 202-2700

monarchmetal.com