

<b>Created By:</b> amh	<b>Approved By:</b>	<b>Sheet Size</b> A	<b>Sheet No.</b> 1/9
<b>Creation Date:</b> 7/25/2024	<b>Approval Date:</b>	<b>Scale</b> 1:1	<b>Rev</b> 2

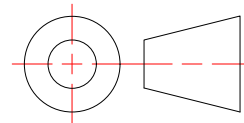

**MCG-3-24**

Weight: 2.557 lbmass  
Stainless Steel  
Finish: #4 Brushed



**MONARCH**  
METAL INC.

**PROPRIETARY AND CONFIDENTIAL**

THE INFORMATION CONTAINED IN THIS DRAWING IS THE SOLE PROPERTY OF MONARCH METAL FABRICATION. ANY REPRODUCTION IN PART OR AS A WHOLE WITHOUT THE WRITTEN PERMISSION OF MONARCH METAL INC. IS PROHIBITED.

**New York**  
1700 Ocean Ave Suite 2  
Ronkonkoma NY 11779  
Phone: (631) 750-3000

**Nevada**  
1080 Linda Way, Unit 10  
Sparks, NV 89431  
Phone: (775) 415-0100

**Texas**  
1330 Post & Paddock St.,  
Suite 800  
Grand Prairie, TX 75050  
(945) 202-2700

monarchmetal.com

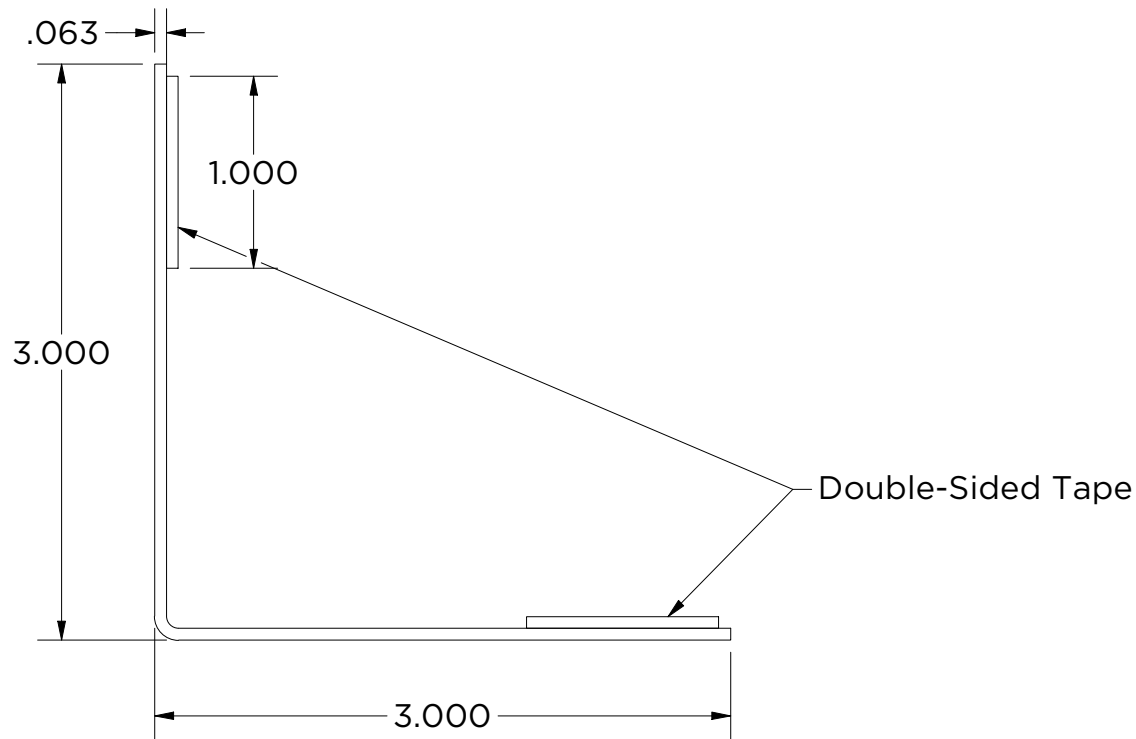

<b>Created By:</b> amh	<b>Approved By:</b>	<b>Sheet Size</b> A	<b>Sheet No.</b> 2/9
<b>Creation Date:</b> 7/25/2024	<b>Approval Date:</b>	<b>Scale</b> 1/7	<b>Rev</b> 2

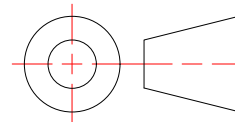

**MCG-3-24T**

Weight: 2.557 lbmass  
Stainless Steel  
Finish: #4 Brushed



**MONARCH**  
METAL INC.

**PROPRIETARY AND CONFIDENTIAL**

THE INFORMATION CONTAINED IN THIS DRAWING IS THE SOLE PROPERTY OF MONARCH METAL FABRICATION. ANY REPRODUCTION IN PART OR AS A WHOLE WITHOUT THE WRITTEN PERMISSION OF MONARCH METAL INC. IS PROHIBITED.

**New York**  
1700 Ocean Ave Suite 2  
Ronkonkoma NY 11779  
Phone: (631) 750-3000

**Nevada**  
1080 Linda Way, Unit 10  
Sparks, NV 89431  
Phone: (775) 415-0100

**Texas**  
1330 Post & Paddock St.,  
Suite 800  
Grand Prairie, TX 75050  
(945) 202-2700

monarchmetal.com

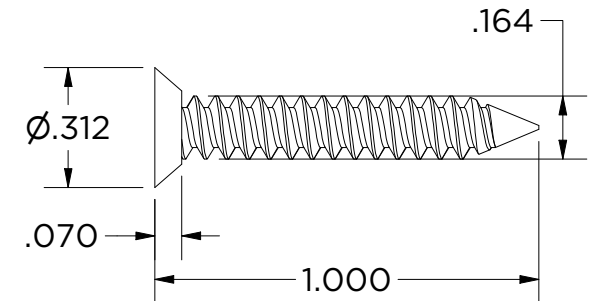
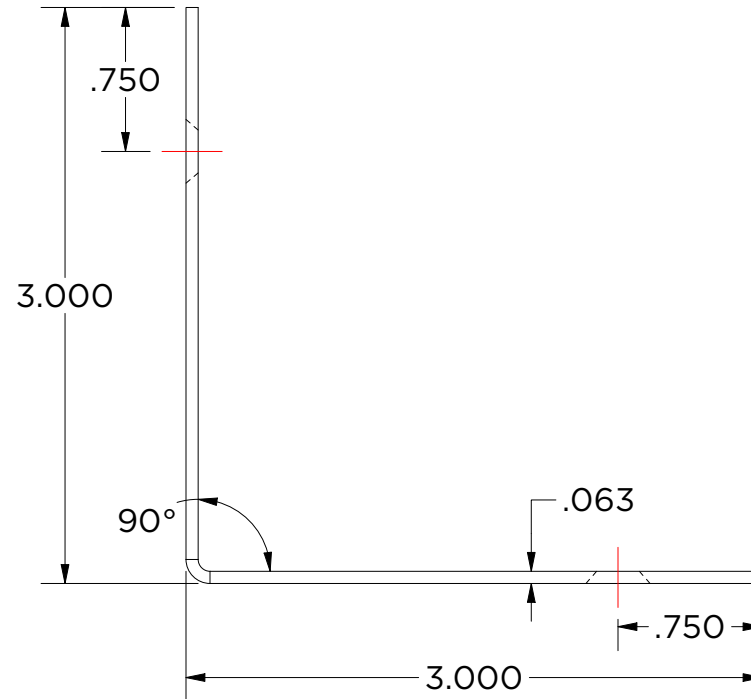
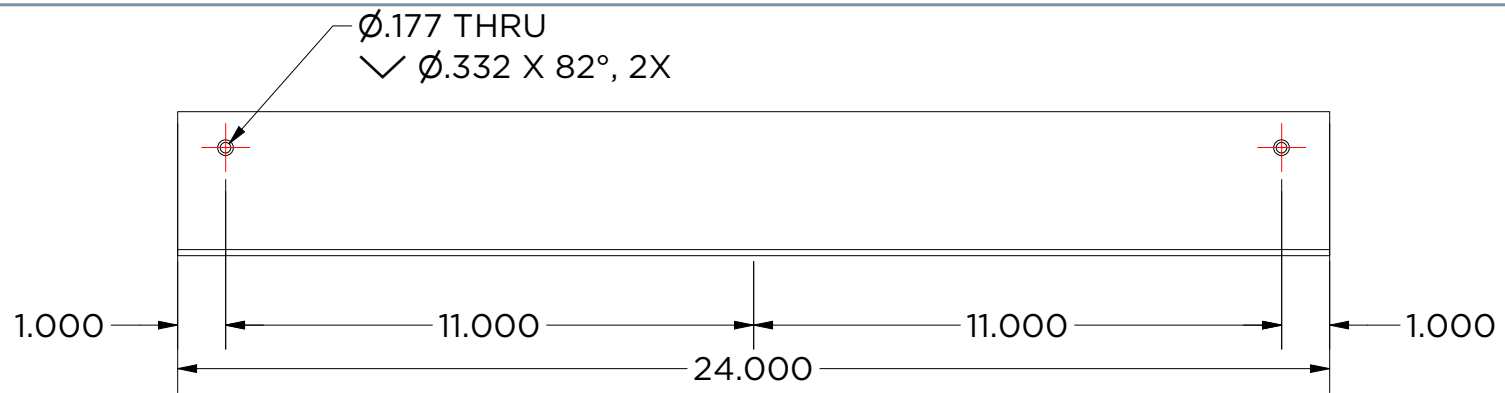

18-8 Stainless Undercut #8x1 Screw  
 QTY (4)

Created By: amh	Approved By:	Sheet Size A	Sheet No. 3/9
Creation Date: 7/25/2024	Approval Date:	Scale 1:1	Rev 2

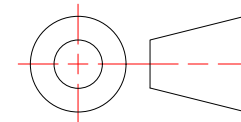

MCG-3-24H

Weight: 1.690 lbmass  
 Stainless Steel  
 Finish: #4 Brushed



**MONARCH**  
 METAL INC.

**PROPRIETARY AND CONFIDENTIAL**

THE INFORMATION CONTAINED IN THIS DRAWING IS THE SOLE PROPERTY OF MONARCH METAL FABRICATION. ANY REPRODUCTION IN PART OR AS A WHOLE WITHOUT THE WRITTEN PERMISSION OF MONARCH METAL INC. IS PROHIBITED.

**New York**  
 1700 Ocean Ave Suite 2  
 Ronkonkoma NY 11779  
 Phone: (631) 750-3000

**Nevada**  
 1080 Linda Way, Unit 10  
 Sparks, NV 89431  
 Phone: (775) 415-0100

**Texas**  
 1330 Post & Paddock St.,  
 Suite 800  
 Grand Prairie, TX 75050  
 (945) 202-2700

monarchmetal.com

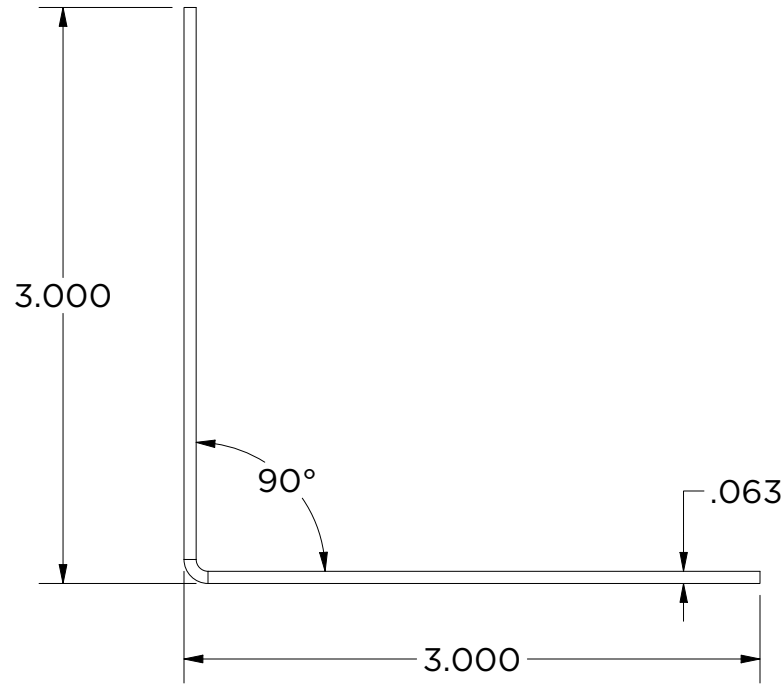

<b>Created By:</b> amh	<b>Approved By:</b>	<b>Sheet Size</b> A	<b>Sheet No.</b> 4/9
<b>Creation Date:</b> 7/25/2024	<b>Approval Date:</b>	<b>Scale</b> 1:1	<b>Rev</b> 2

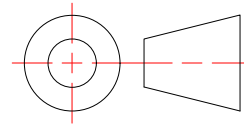

**MCG-3-48**

Weight: 1.690 lbmass  
Stainless Steel  
Finish: #4 Brushed



**MONARCH**  
METAL INC.

**PROPRIETARY AND CONFIDENTIAL**

THE INFORMATION CONTAINED IN THIS DRAWING IS THE SOLE PROPERTY OF MONARCH METAL FABRICATION. ANY REPRODUCTION IN PART OR AS A WHOLE WITHOUT THE WRITTEN PERMISSION OF MONARCH METAL INC. IS PROHIBITED.

**New York**  
1700 Ocean Ave Suite 2  
Ronkonkoma NY 11779  
Phone: (631) 750-3000

**Nevada**  
1080 Linda Way, Unit 10  
Sparks, NV 89431  
Phone: (775) 415-0100

**Texas**  
1330 Post & Paddock St.,  
Suite 800  
Grand Prairie, TX 75050  
(945) 202-2700

monarchmetal.com

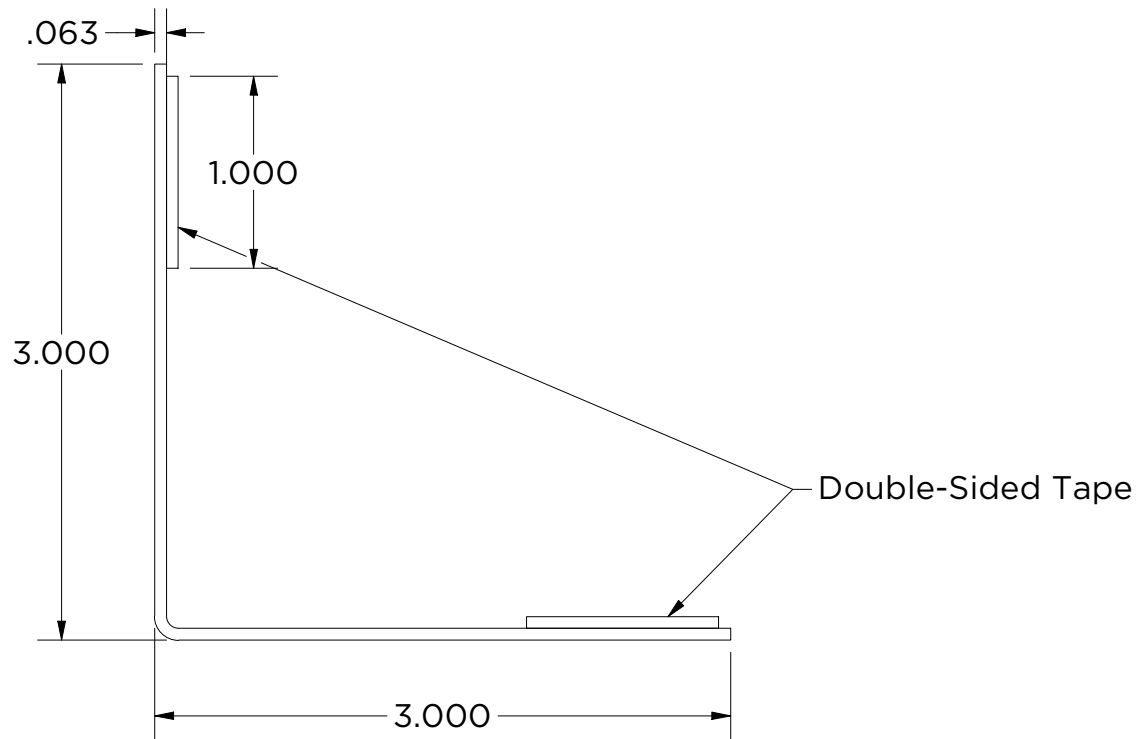

<b>Created By:</b> amh	<b>Approved By:</b>	<b>Sheet Size</b> A	<b>Sheet No.</b> 5/9
<b>Creation Date:</b> 7/25/2024	<b>Approval Date:</b>	<b>Scale</b> 1 / 14	<b>Rev</b> 2

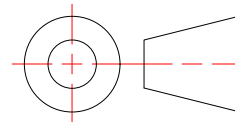

**MCG-3-48T**

Weight: 1.690 lbmass  
Stainless Steel  
Finish: #4 Brushed



**MONARCH**  
METAL INC.

**PROPRIETARY AND CONFIDENTIAL**

THE INFORMATION CONTAINED IN THIS DRAWING IS THE SOLE PROPERTY OF MONARCH METAL FABRICATION. ANY REPRODUCTION IN PART OR AS A WHOLE WITHOUT THE WRITTEN PERMISSION OF MONARCH METAL INC. IS PROHIBITED.

**New York**  
1700 Ocean Ave Suite 2  
Ronkonkoma NY 11779  
Phone: (631) 750-3000

**Nevada**  
1080 Linda Way, Unit 10  
Sparks, NV 89431  
Phone: (775) 415-0100

**Texas**  
1330 Post & Paddock St.,  
Suite 800  
Grand Prairie, TX 75050  
(945) 202-2700

monarchmetal.com

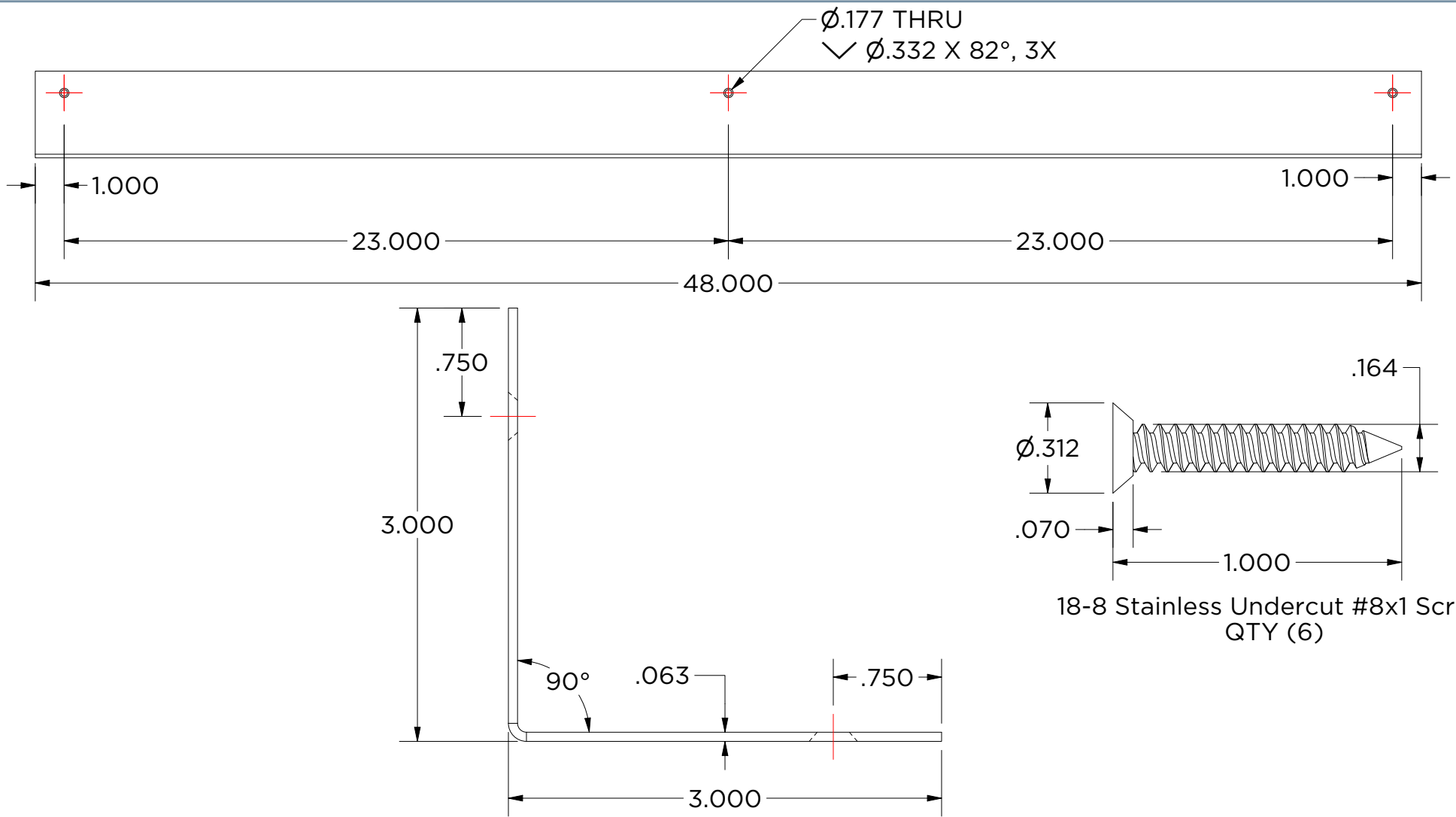

<b>Created By:</b> amh	<b>Approved By:</b>	<b>Sheet Size</b> A	<b>Sheet No.</b> 6/9
<b>Creation Date:</b> 7/25/2024	<b>Approval Date:</b>	<b>Scale</b> 1:1	<b>Rev</b> 2

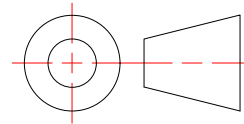

**MCG-3-48H**

Weight: 1.690 lbmass  
Stainless Steel  
Finish: #4 Brushed



**MONARCH**  
METAL INC.

**PROPRIETARY AND CONFIDENTIAL**

THE INFORMATION CONTAINED IN THIS DRAWING IS THE SOLE PROPERTY OF MONARCH METAL FABRICATION. ANY REPRODUCTION IN PART OR AS A WHOLE WITHOUT THE WRITTEN PERMISSION OF MONARCH METAL INC. IS PROHIBITED.

**New York**  
1700 Ocean Ave Suite 2  
Ronkonkoma NY 11779  
Phone: (631) 750-3000

**Nevada**  
1080 Linda Way, Unit 10  
Sparks, NV 89431  
Phone: (775) 415-0100

**Texas**  
1330 Post & Paddock St.,  
Suite 800  
Grand Prairie, TX 75050  
(945) 202-2700

monarchmetal.com

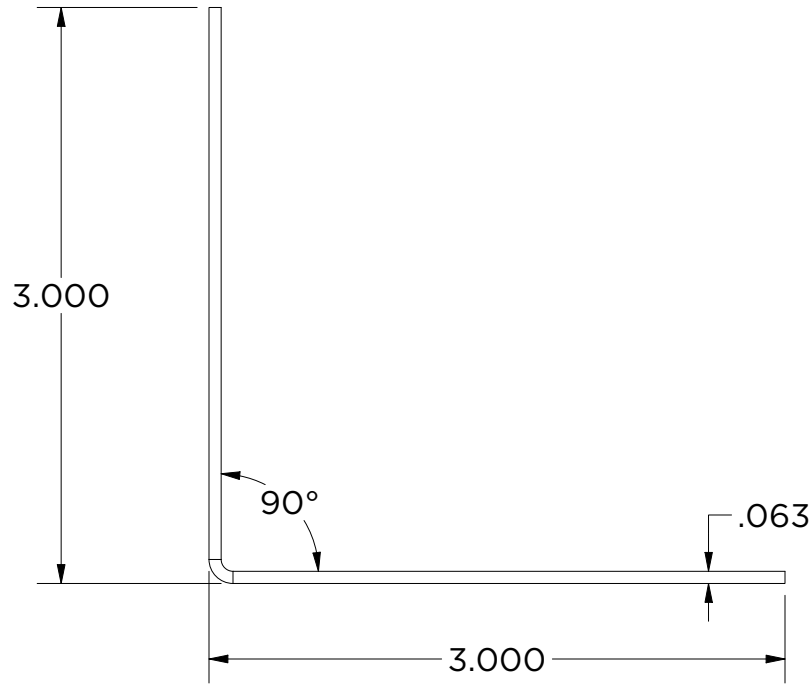

<b>Created By:</b> amh	<b>Approved By:</b>	<b>Sheet Size</b> A	<b>Sheet No.</b> 7/9
<b>Creation Date:</b> 7/25/2024	<b>Approval Date:</b>	<b>Scale</b> 1:1	<b>Rev</b> 2

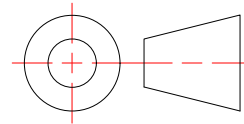

**MCG-3-92**

Weight: 1.690 lbmass  
Stainless Steel  
Finish: #4 Brushed



**MONARCH**  
METAL INC.

**PROPRIETARY AND CONFIDENTIAL**

THE INFORMATION CONTAINED IN THIS DRAWING IS THE SOLE PROPERTY OF MONARCH METAL FABRICATION. ANY REPRODUCTION IN PART OR AS A WHOLE WITHOUT THE WRITTEN PERMISSION OF MONARCH METAL INC. IS PROHIBITED.

**New York**  
1700 Ocean Ave Suite 2  
Ronkonkoma NY 11779  
Phone: (631) 750-3000

**Nevada**  
1080 Linda Way, Unit 10  
Sparks, NV 89431  
Phone: (775) 415-0100

**Texas**  
1330 Post & Paddock St.,  
Suite 800  
Grand Prairie, TX 75050  
(945) 202-2700

monarchmetal.com

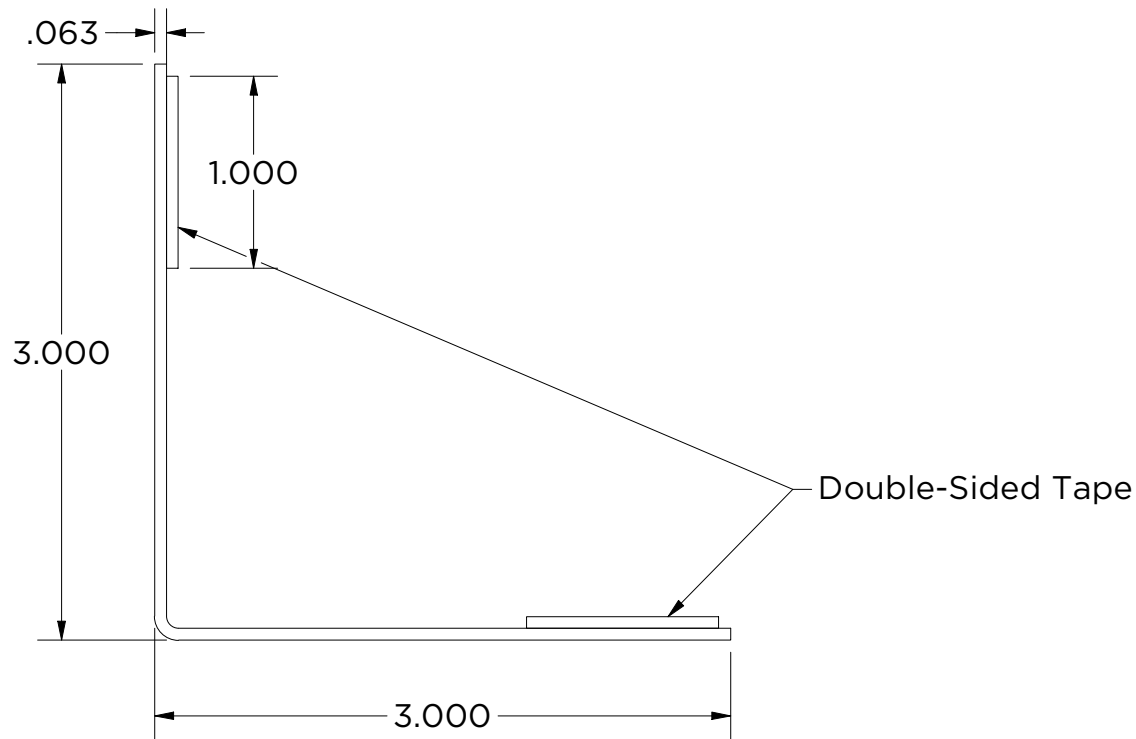

<b>Created By:</b> amh	<b>Approved By:</b>	<b>Sheet Size</b> A	<b>Sheet No.</b> 8/9
<b>Creation Date:</b> 7/25/2024	<b>Approval Date:</b>	<b>Scale</b> 1 / 28	<b>Rev</b> 2

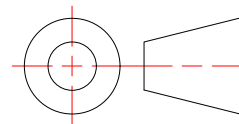

**MCG-3-92T**

Weight: 1.690 lbmass  
Stainless Steel  
Finish: #4 Brushed



**MONARCH**  
METAL INC.

**PROPRIETARY AND CONFIDENTIAL**

THE INFORMATION CONTAINED IN THIS DRAWING IS THE SOLE PROPERTY OF MONARCH METAL FABRICATION. ANY REPRODUCTION IN PART OR AS A WHOLE WITHOUT THE WRITTEN PERMISSION OF MONARCH METAL INC. IS PROHIBITED.

**New York**  
1700 Ocean Ave Suite 2  
Ronkonkoma NY 11779  
Phone: (631) 750-3000

**Nevada**  
1080 Linda Way, Unit 10  
Sparks, NV 89431  
Phone: (775) 415-0100

**Texas**  
1330 Post & Paddock St.,  
Suite 800  
Grand Prairie, TX 75050  
(945) 202-2700

monarchmetal.com

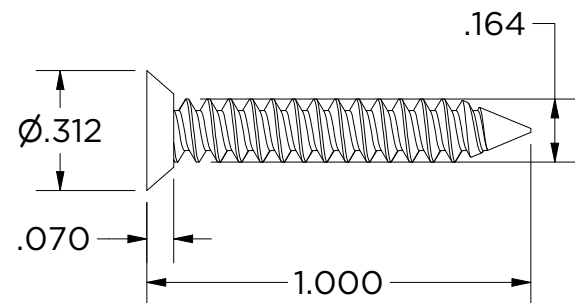
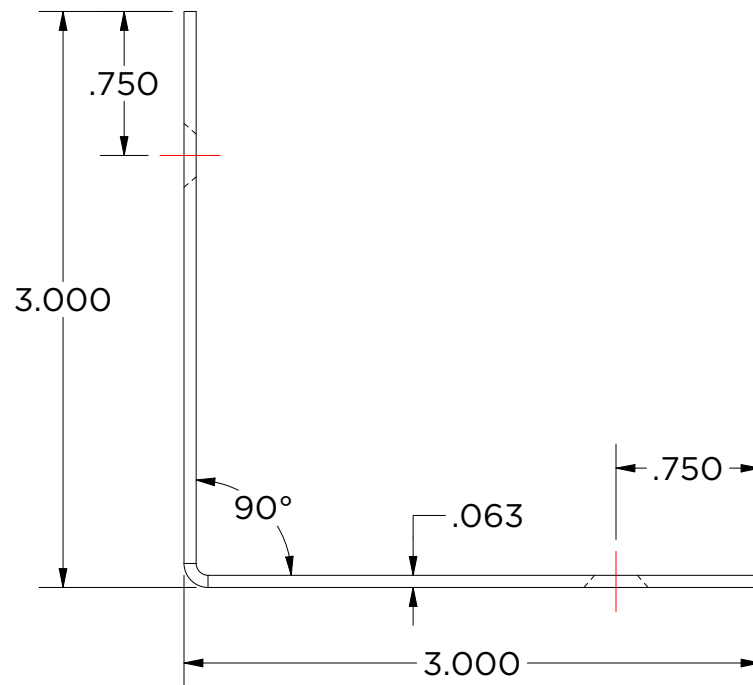
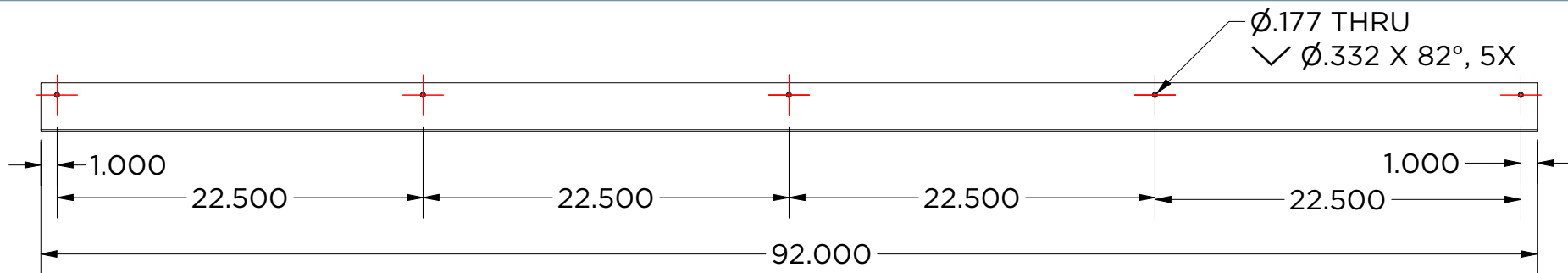

18-8 Stainless Undercut #8x1 Screw  
QTY (10)

<b>Created By:</b> amh	<b>Approved By:</b>	<b>Sheet Size</b> A	<b>Sheet No.</b> 9/9
<b>Creation Date:</b> 7/25/2024	<b>Approval Date:</b>	<b>Scale</b> 1:1	<b>Rev</b> 2

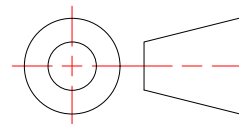

**MCG-3-92H**

Weight: 9.789 lbmass  
Stainless Steel  
Finish: #4 Brushed



**MONARCH**  
METAL INC.

**PROPRIETARY AND CONFIDENTIAL**

THE INFORMATION CONTAINED IN THIS DRAWING IS THE SOLE PROPERTY OF MONARCH METAL FABRICATION. ANY REPRODUCTION IN PART OR AS A WHOLE WITHOUT THE WRITTEN PERMISSION OF MONARCH METAL INC. IS PROHIBITED.

**New York**  
1700 Ocean Ave Suite 2  
Ronkonkoma NY 11779  
Phone: (631) 750-3000

**Nevada**  
1080 Linda Way, Unit 10  
Sparks, NV 89431  
Phone: (775) 415-0100

**Texas**  
1330 Post & Paddock St.,  
Suite 800  
Grand Prairie, TX 75050  
(945) 202-2700

monarchmetal.com